

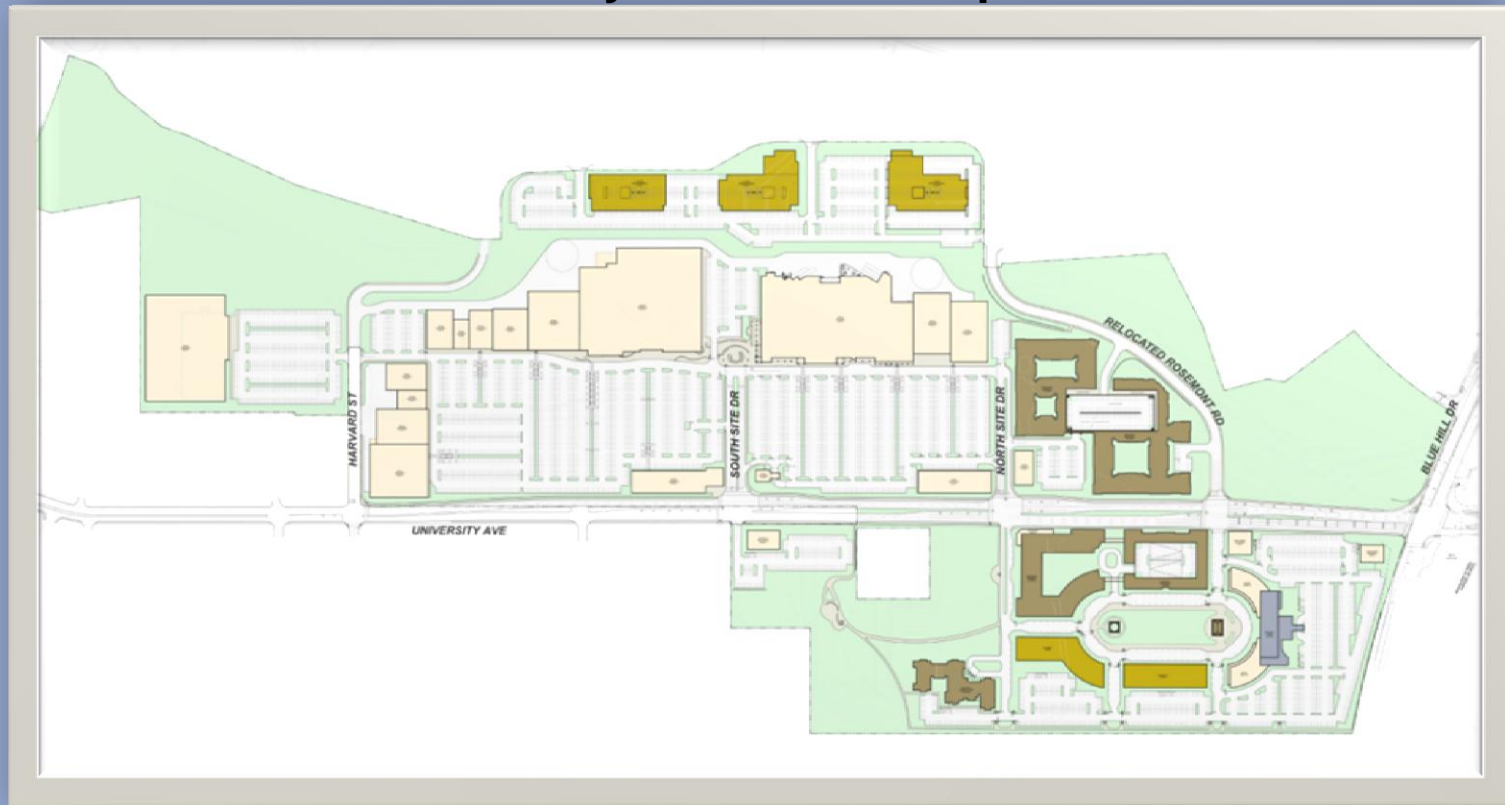

# Town of Westwood

## Presentation to The Westwood Planning Board Traffic Peer Review Services University Station Development



January 29, 2013

Presented by:





# Introductions



- **Kien Ho - Traffic Task Leader**
- **Merrick Turner – Project Manager**
- **Greg Lucas - Traffic Analyst**
- **Najib Habesch - Neighborhood Liaison**





# Review Objectives



- Traffic Generation and Distribution Methodology
- Study Area
- Traffic Analysis Methodology, Operational Results
- On-Site and Off-Site Traffic Mitigations





# Trip Gen and Trip Dist



- Original Trip Gen Report October 2012
- Full Traffic Study November 30, 2012
- Meetings/Extra Data Collection/Analysis
- Study Limits
- Extra Study Locations
- Standard ITE Methodology





# University Ave. Operations



- Reviewed 2017 and 2022 Conditions
- 2022 Redistribution due to the Dedham Street Improvements
- AM Operations
  - Dedham Street Right Turn Lane
- PM Operations
  - Queues at Northerly End
- Saturday Operations
  - Queues at Northerly End
- Pedestrian Crossing





# Dedham/Canton/University Option 1

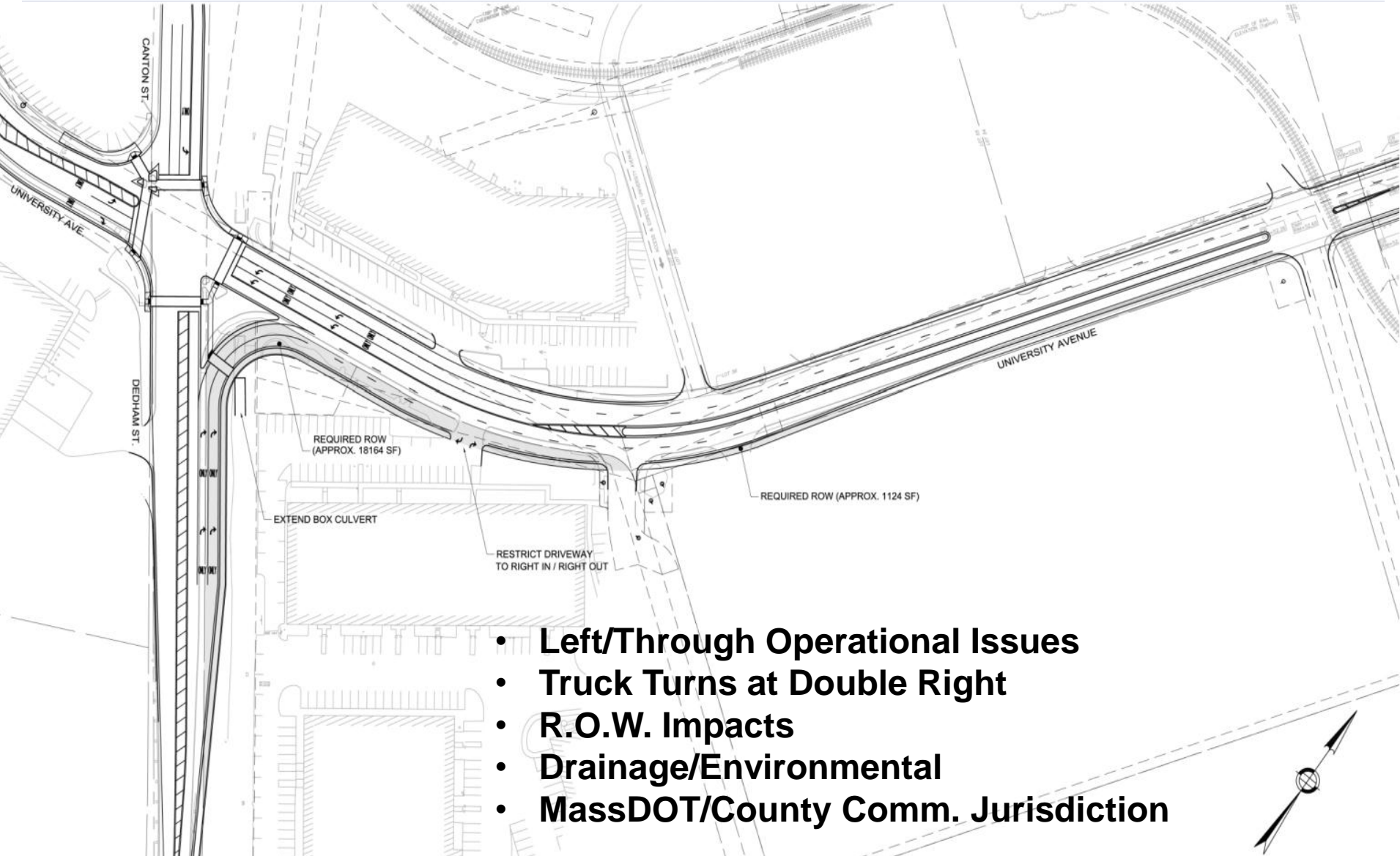

- **Left/Through Operational Issues**
- **Truck Turns at Double Right**
- **R.O.W. Impacts**
- **Drainage/Environmental**
- **MassDOT/County Comm. Jurisdiction**





# Dedham/Canton/University Option 2



- **Operational Issues**
- **Truck Access to Oceana**
- **Truck Turns at Double Right**
- **Cost/Complexity**
- **R.O.W. Impacts**
- **Drainage/Environmental**
- **MassDOT/County Comm. Jurisdiction**

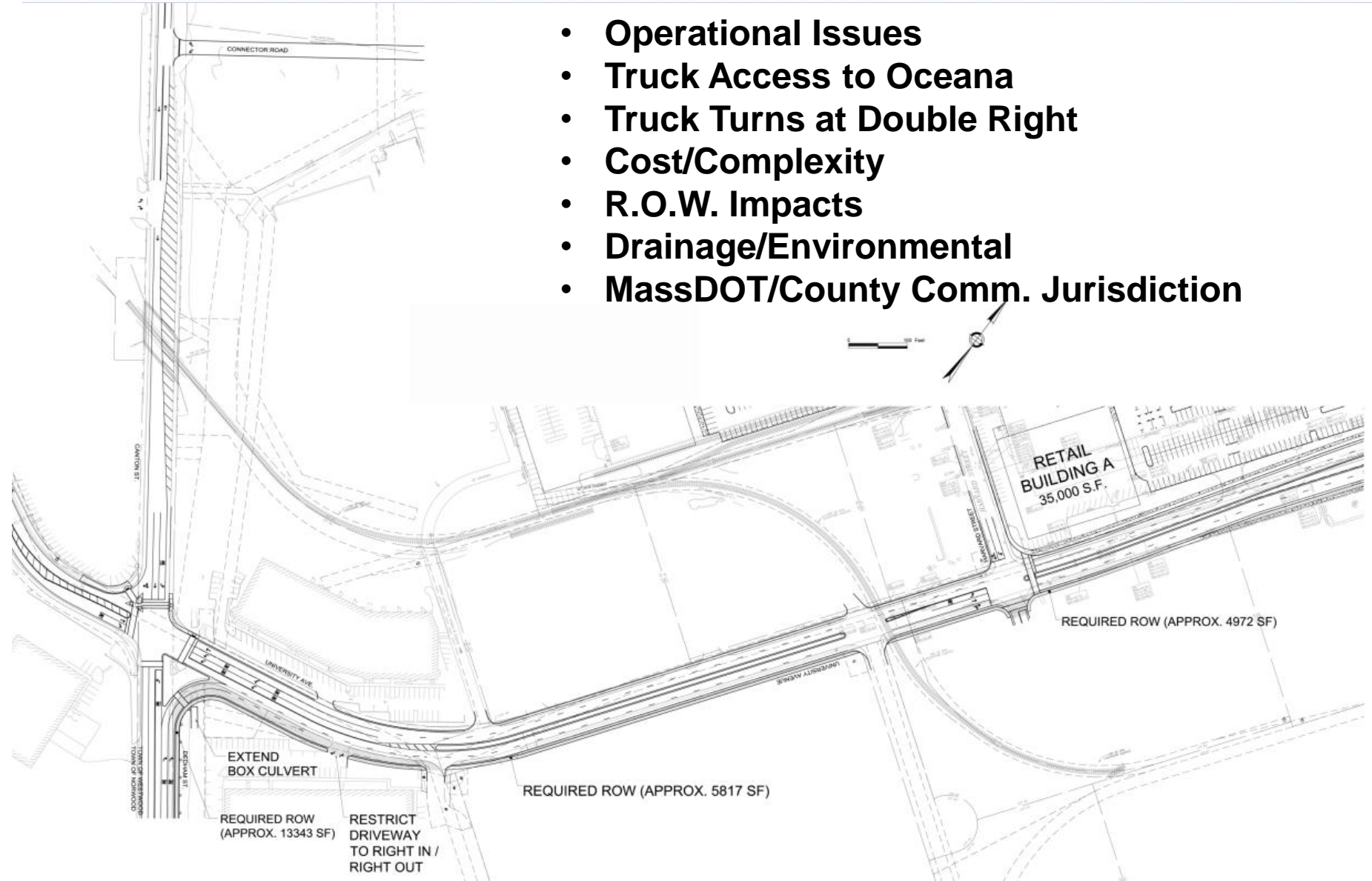



# Off-Site Operations



- Study Limits Appropriate – 30 Intersections
- Impacts and Issues Identified
- Canton/Norwood/MassDOT jurisdictions







# Mitigations

- Canton Street Mitigation Commitment
- Monitoring Process
  - Frequency
  - Major Phases – Baseline, Core Development, Retail Village, Office.
- Other Westwood Mitigations
  - Studies Required





# Summary & A



- Overall Traffic Report
- Moving in the Right Direction
- More Work to be Done
- Community Input
- MassDOT Input





# Q&A

