

# University Station

## Westwood, Massachusetts

January 29, 2013



# Site Plan

P:\9559\127-3659-12003\Site Plan.ai



Legend	
	Retail/Restaurant
	Residential
	Office
	Hotel

University Station  
Westwood, Massachusetts

Site Plan

Figure 1

# Study Area Intersections



University Station  
Westwood, Massachusetts

# Mitigation Summary



Location	Mitigation
<b>Westwood</b>	
Canton Street	<ul style="list-style-type: none"><li>• Perform Traffic Monitoring</li><li>• Install Traffic Calming Devices as indicated by Traffic Monitoring<ul style="list-style-type: none"><li>- Peak Period Turn Restrictions</li><li>- Raised Crosswalks</li><li>- Traffic Circles</li><li>- Traffic Diverters</li><li>- Speed Tables</li><li>- Roadway Narrowing</li></ul></li></ul>
Nahatan Street/Clapboardtree St	<ul style="list-style-type: none"><li>• Perform Traffic Monitoring</li><li>• Conduct a Traffic Safety Study and Implement Recommendations</li></ul>
Route 1A/Everett Street/ University Ave. (MassDOT)	<ul style="list-style-type: none"><li>• Conduct a Traffic Safety Study and Implement Recommendations</li><li>• Optimize Traffic Signal Timing</li><li>• Provide Traffic Signal Timing and Phasing Plan</li></ul>
East Street Rotary (MassDOT)	<ul style="list-style-type: none"><li>• Conduct a Traffic Safety Study and Implement Recommendations</li><li>• Prepare PS &amp; E as indicated by Safety Study</li></ul>

# Mitigation Summary



Location	Mitigation
<b>Canton</b>	
Dedham Street/Washington Street	<ul style="list-style-type: none"><li>• Provide PS &amp; E for intersection improvements including a right turn lane on Dedham Street and traffic signal improvements</li></ul>
Route 138/Washington Street	<ul style="list-style-type: none"><li>• Conduct a Traffic Safety Study and Implement Recommendations</li></ul>
Route 138/Randolph Street	<ul style="list-style-type: none"><li>• Conduct a Traffic Safety Study and Implement Recommendations</li><li>• Optimize Traffic Signal Timing</li><li>• Provide Traffic Signal Timing and Phasing Plan</li></ul>
Route 138/ Green Lodge Street	<ul style="list-style-type: none"><li>• Conduct a Traffic Signal Warrant Analysis for existing conditions</li><li>• Conduct a Traffic Signal Warrant Analysis after the proposed project is fully built and occupied</li><li>• If signalization is warranted and desired by the community, prepare PS &amp; E for intersection improvements including a traffic signal.</li></ul>
Dedham Street/Shawmut Road	<ul style="list-style-type: none"><li>• Provide PS &amp; E for intersection improvements including a 100 foot right turn lane on Shawmut Road.</li></ul>
Dedham Street/Elm Street	<ul style="list-style-type: none"><li>• Conduct a Traffic Signal Warrant Analysis for existing conditions</li><li>• Conduct a Traffic Signal Warrant Analysis after the proposed project is fully built and occupied</li><li>• If signalization is warranted and desired by the community, prepare PS &amp; E for intersection improvements including a traffic signal.</li></ul>

# Mitigation Summary



Location	Mitigation
<b>Norwood</b>	
Route 1/Everett Street/ University Avenue (MassDOT)	<ul style="list-style-type: none"><li>• Conduct a Traffic Safety Study and Implement Recommendations</li><li>• Optimize Traffic Signal Timing/Evaluate Left Turn Phase</li><li>• Provide Traffic Signal Timing and Phasing Plan</li></ul>
Neponset Circle (MassDOT)	<ul style="list-style-type: none"><li>• Conduct a Traffic Safety Study and Implement Recommendations</li><li>• Prepare PS &amp; E as indicated by Safety Study</li></ul>

# Conceptual Improvement Plan University Avenue @ Blue Hill Drive / Green Lodge Street

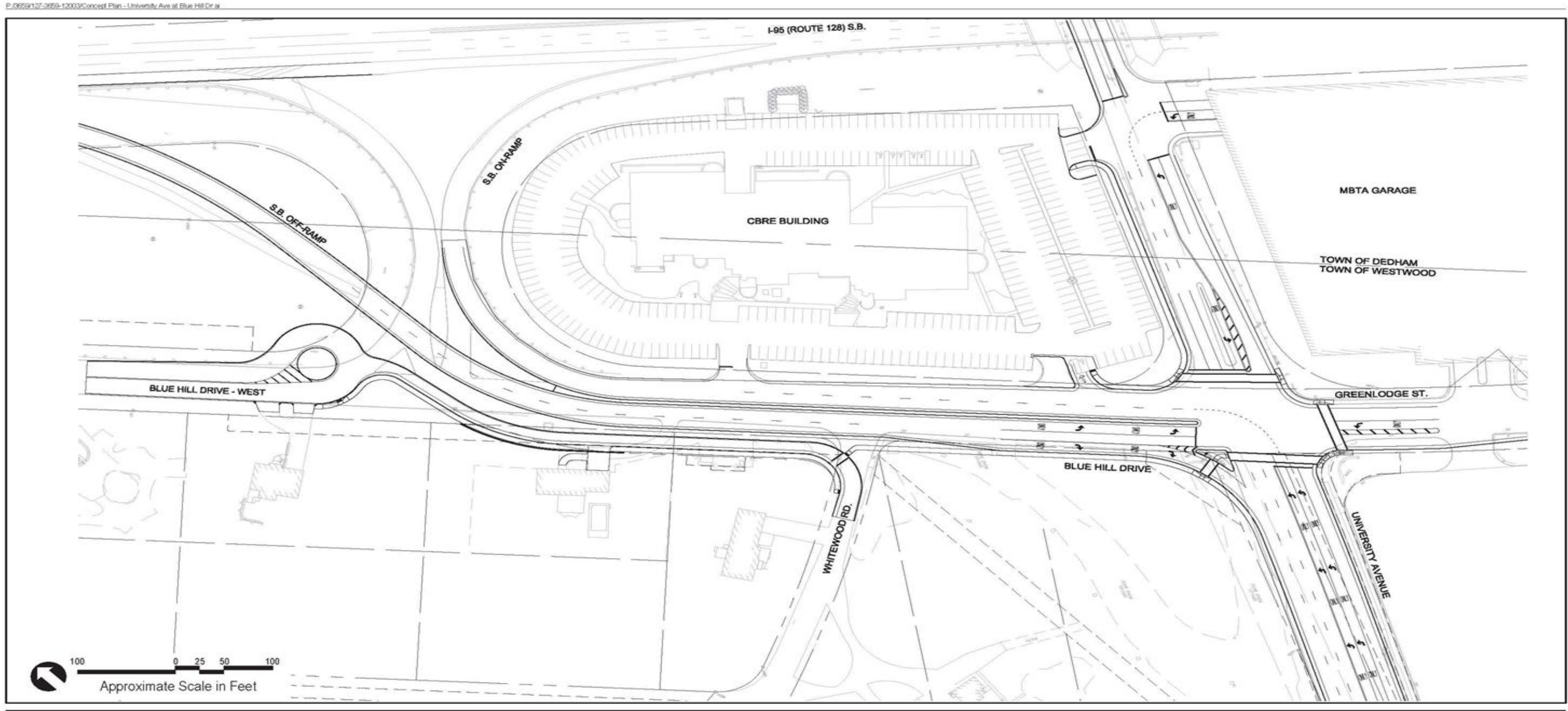

University Station  
Westwood, Massachusetts



Conceptual Improvement Plan  
University Avenue @ Blue Hill Drive / Green Lodge Street Figure 7

# Conceptual Improvement Plan University Avenue @ Canton Street / Dedham Street



P:\0659127-3659-12003\Concept Plan - University Ave at Canton.st

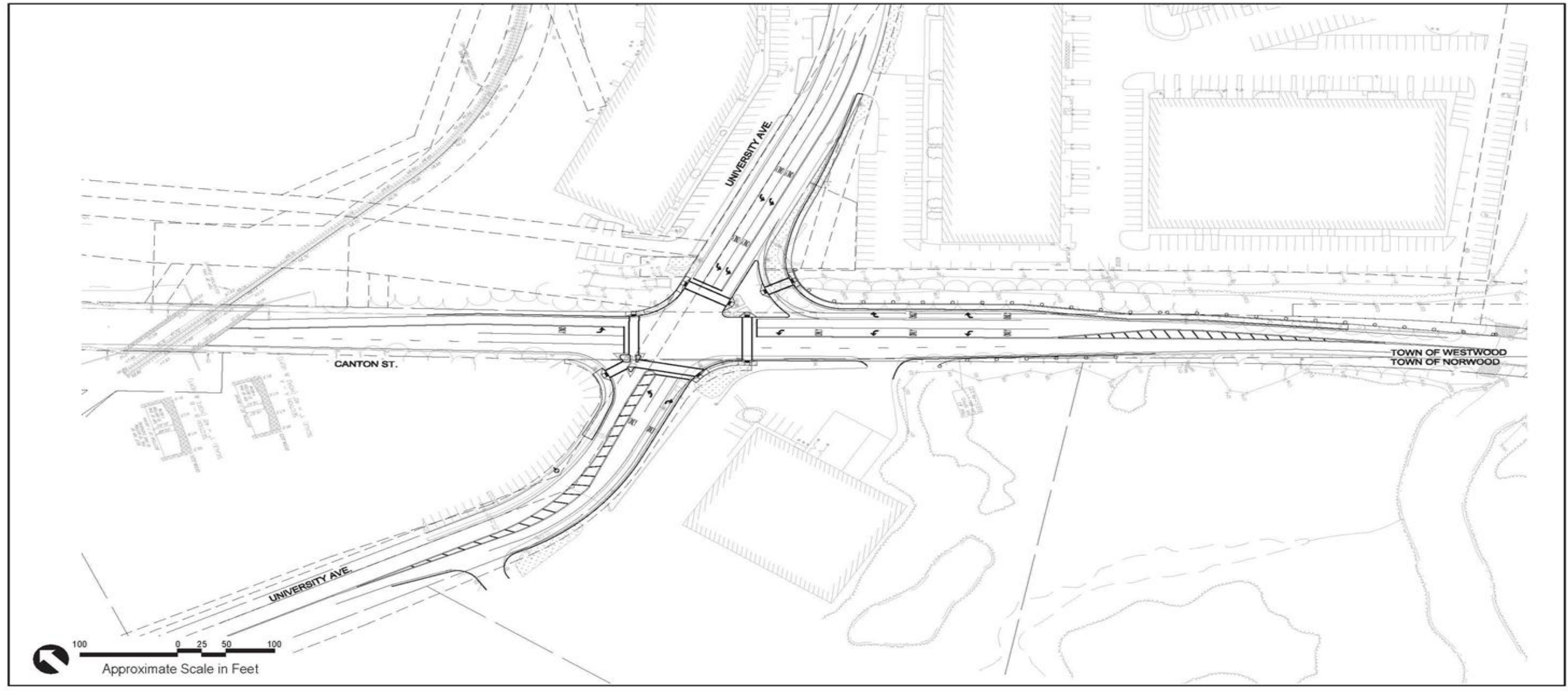

University Station  
Westwood, Massachusetts



Conceptual Improvement Plan (2017)  
University Avenue @ Canton Street / Dedham Street Figure 8



# Conceptual Improvement Plan Dedham Street Corridor



P:\3559\127-3559-12003\Concept Plan Dedham St Corridor.ai



Legend	
	Traffic Signal

University Station  
Westwood, Massachusetts

Conceptual Improven  
Dedham Street Corric



# Conceptual Improvement Plan Dedham Street Corridor



P:\0559\127-3659-12003\Concept Plan Dedham St Corridor.ai



Legend	
	Traffic Signal

University Station  
Westwood, Massachusetts

Conceptual Improve  
Dedham Street Corridor



# Conceptual Plan - University Avenue

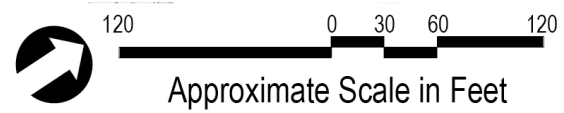
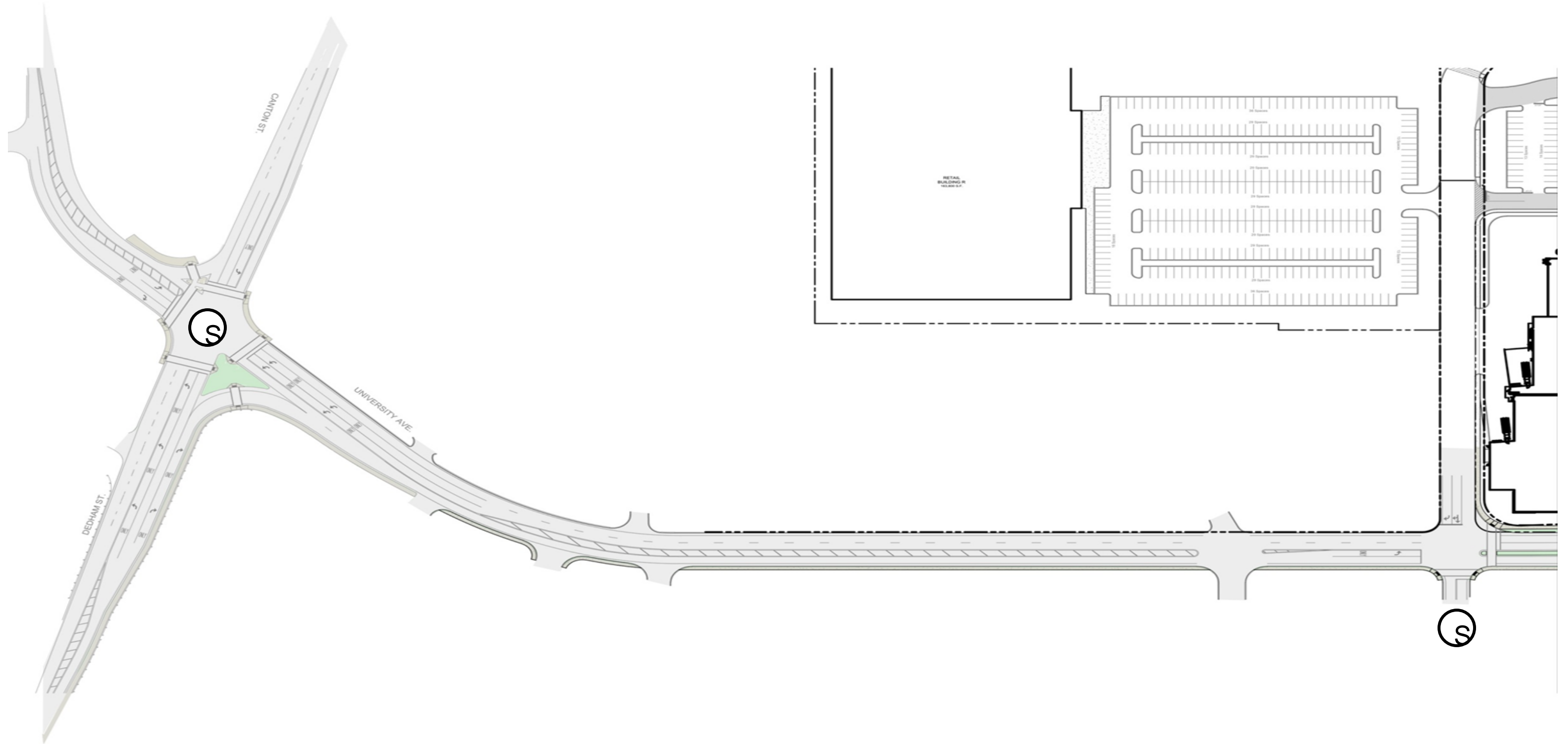

# Conceptual Plan - University Avenue

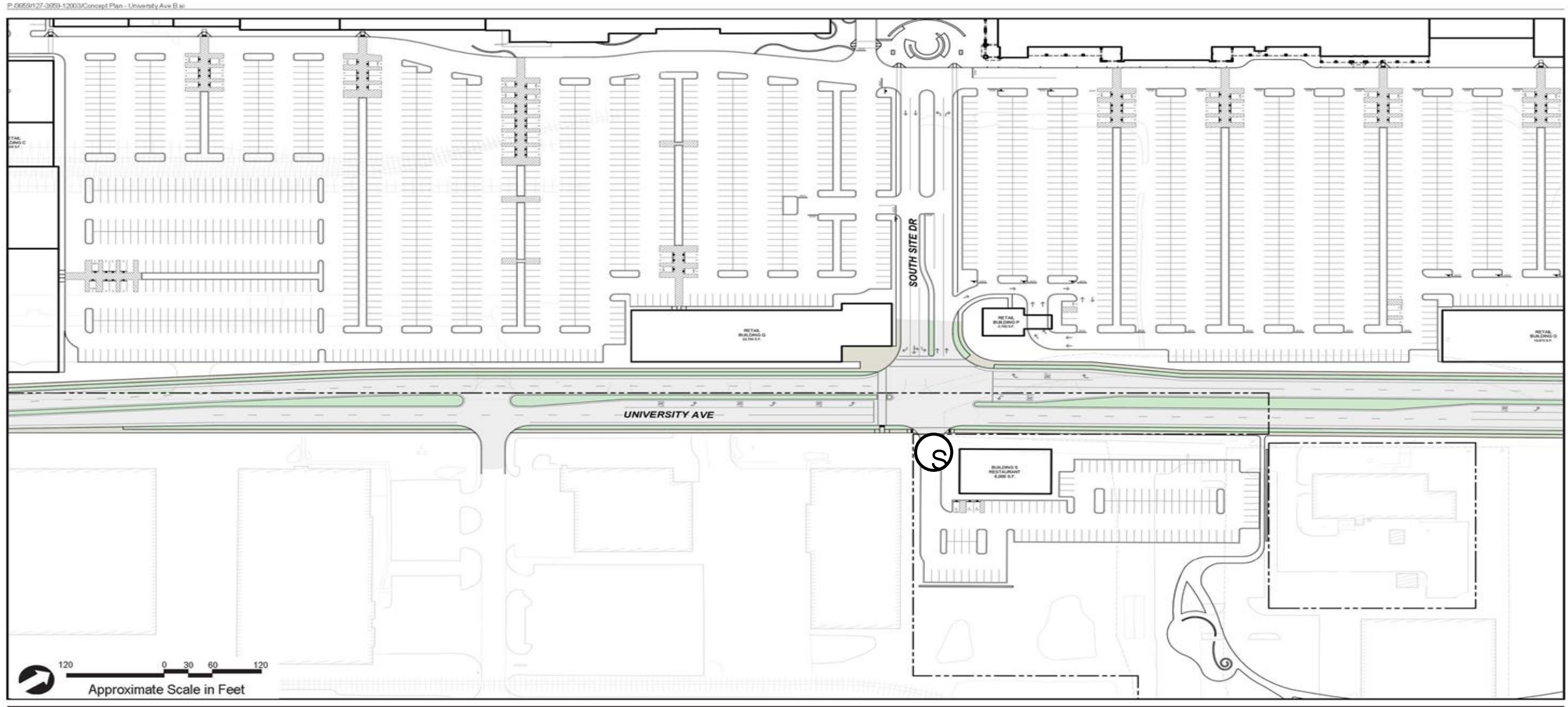

Legend	
	Pavement
	Sidewalk
	Landscape

University Station  
Westwood, Massachusetts

Conceptual Plan  
- University Ave

Figure 10B

# Conceptual Plan - University Avenue

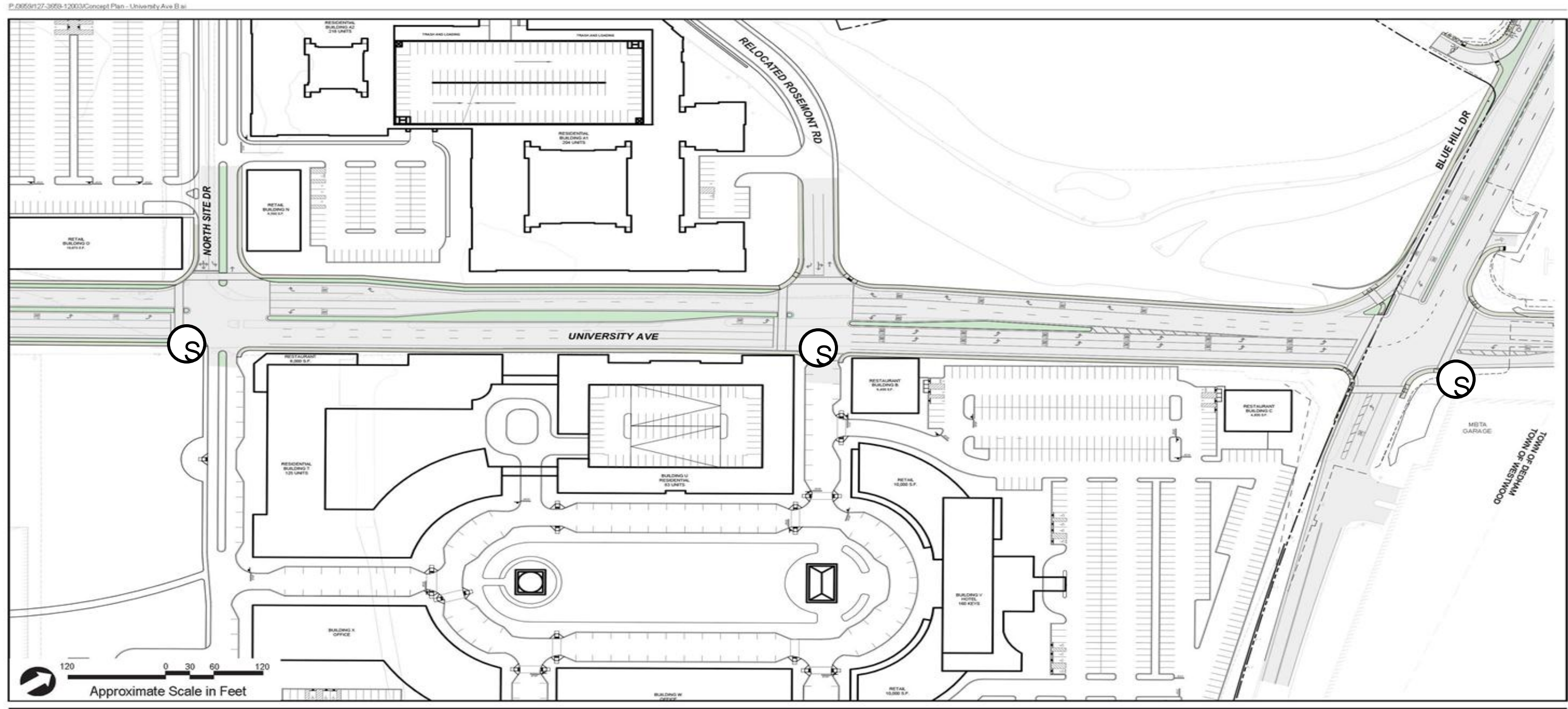

Legend	
	Pavement
	Sidewalk
	Landscape

University Station  
Westwood, Massachusetts

Conceptual Plan  
- University Ave

Figure 10C

# Option 1 Concept Plan - University Avenue / Canton Street with Double Right Turn Lanes

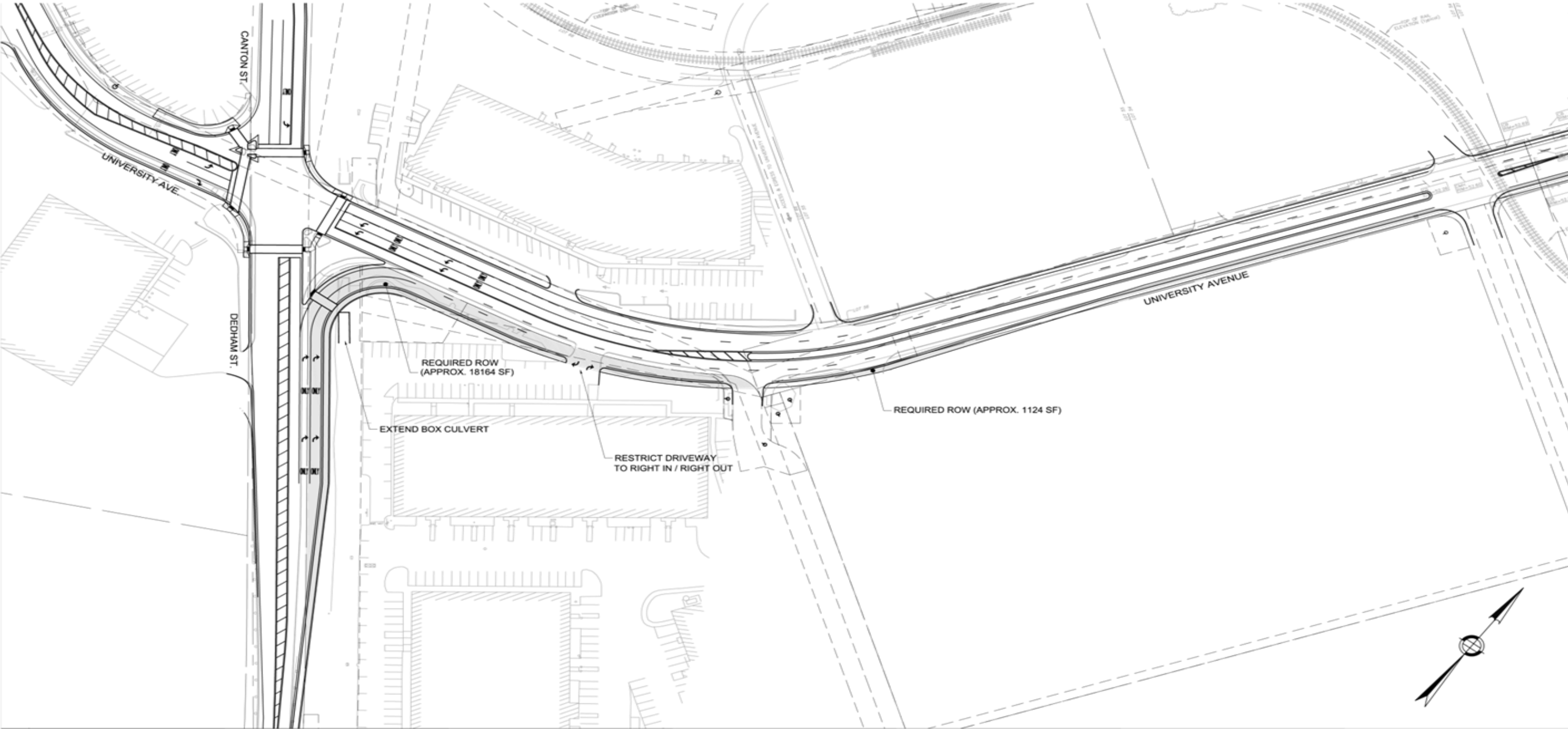

# Option 2 Concept Plan - University Avenue / Canton Street with One-Way Restriction

