

11/20/2012 3:07:15 PM - P:\3659\127-3659-1200\CAD\SHEET\FILES\SITE DEVELOPMENT PLANS\C-111 GRADING & DRAINAGE PLAN.DWG - BECKWITH, JOHN

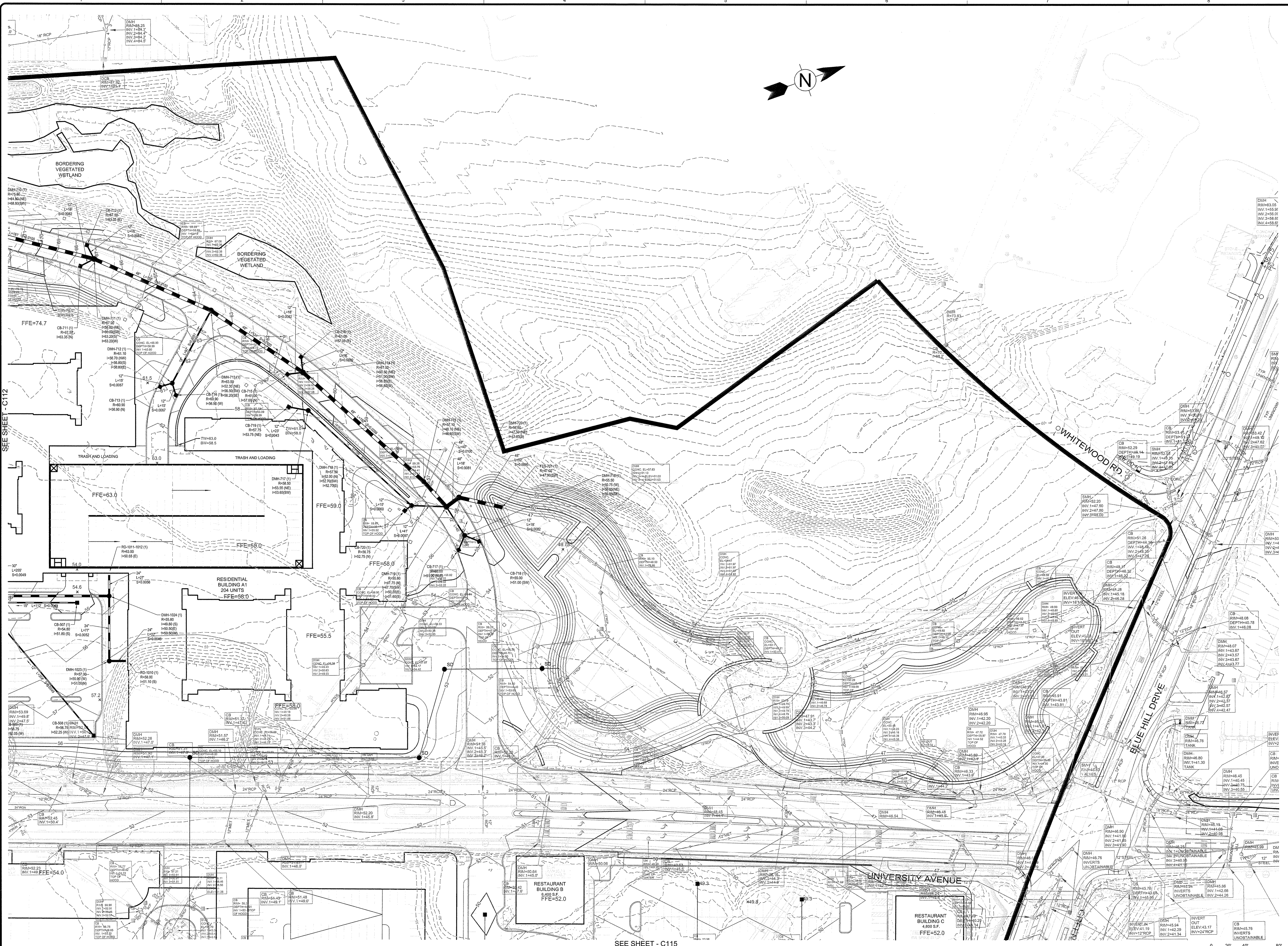

SEE SHEET - C115

SCALE: 1" = 40'

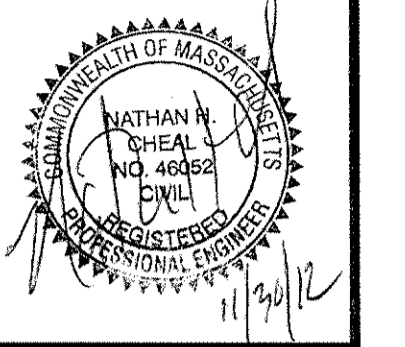

MARK	DATE	DESCRIPTION	BY
1	10/09/12	Preliminary Site Development Plans	N.H.C.
2	11/09/12	Revised Site Development Plans	N.H.C.

Client: Westwood Marketplace Holdings LLC  
 Proj. Loc.: University Ave., Westwood, MA  
 University Station - University Avenue  
 Redevelopment  
**Grading & Drainage Plan**

Project No.: 127-3659-12003  
 Designed By: N.H.C.  
 Drawn By: J.V.B.  
 Checked By: R.F.D.

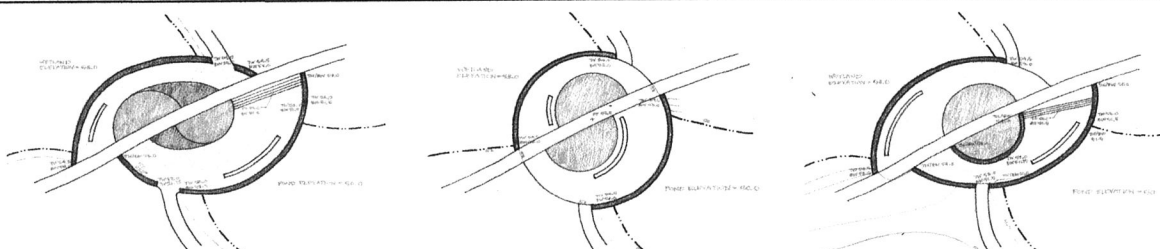

1 OVERLOOK CONCEPT OPTIONS  
SCALE: 1" = 40'-0"



2 KINETIC SCULPTURE PRECEDENT  
SCALE: 1" = 40'-0"

**CONCEPT STATEMENT**

THE PARK AT THE CORNER OF BLUE HILL DRIVE AND UNIVERSITY AVENUE SERVES MANY PURPOSES. THE PARK'S PROMINENT LOCATION REQUIRES IT TO ACT AS A FORMALIZED PARK FOR FUTURE RESIDENCES, AND FINALLY, AS A PLACE FOR STORMWATER STORAGE AND TREATMENT. THE CONCEPTUAL PARK DESIGN TRANSITIONS FROM A NATURALIZED, ORGANIC WETLAND (9 ACRES) AT THE SOUTH INTO A MORE FORMALIZED POND AND WATER FEATURE (1 ACRE) AT THE NORTH WHERE VISITORS FIRST GIMPSE UNIVERSITY STATION. A 35' FOUNTAIN IN THE POND IS THE MAIN FOCAL POINT AS VISITORS ENTER UNIVERSITY STATION. THE WETLAND IS ANCHORED BY A KINETIC SCULPTURE THAT RESPONDS TO THE ORGANIC QUALITY OF THIS SPACE. A CENTRAL WALKWAY BISECTS THE PARK WHILE ADDITIONAL MEANDERING WALKWAYS PROVIDE CIRCULATION ALONG THE PERIPHERY OF THE PARK. A CENTRAL OVERLOOK OFFERS SEATING OPPORTUNITIES AND VIEWS OF THE POND AND WETLAND. THE PLANTING PALETTE WILL CONSIST OF A RIBBON OF NATIVE WETLAND PLANTS MEANDERING THROUGH THE PARK WHILE THE TREE CANOPY WILL CONSIST OF NATIVE SPECIES RANDOMLY PLACED TO CREATE A WOODLAND EFFECT.

PREPARED BY:  
**Shadley Associates**  
LANDSCAPE ARCHITECTS  
1770 Main Street, Suite 200 • P.O. Box 100  
Lebanon, NH 03757 • P: 603.448.2800  
www.shadleyassociates.com

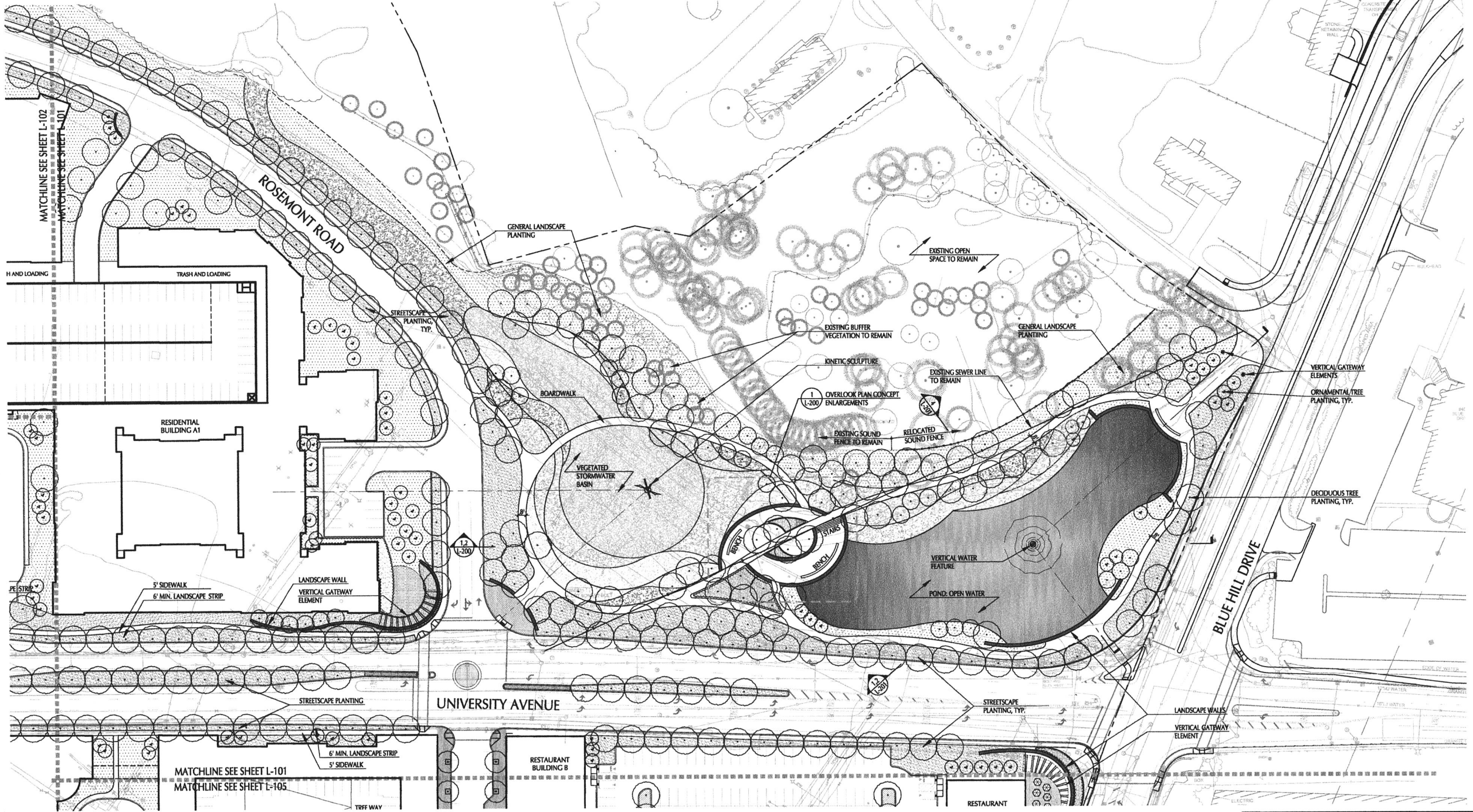

**PLANTING LEGEND**

	EXISTING DECIDUOUS TREE TO REMAIN		DECIDUOUS TREE PLANTING		TREE WAY PLANTING
	EXISTING EVERGREEN TREE TO REMAIN		EVERGREEN TREE PLANTING		PROPOSED TREE LINE
	EXISTING TREE LINE		ORNAMENTAL TREE PLANTING		PARKS AND PLAZAS PLANTING

**STREETScape LEGEND**

	ENHANCED STREETScape TREATMENT AREA		WETLAND PLANTING
	SPECIALTY PAVEMENT		LAWN, SEEDED
	CONCRETE PAVEMENT		MEADOW, SEEDED
	STREETScape PLANTING		PARKING LOT PLANTING
	GENERAL LANDSCAPE PLANTING		

**STREETScape LEGEND**

	ENHANCED STREETScape TREATMENT AREA
	SPECIALTY PAVEMENT
	CONCRETE PAVEMENT

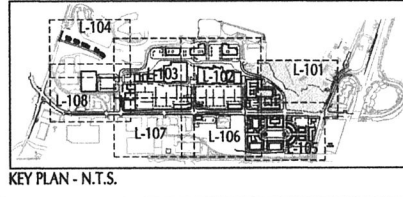
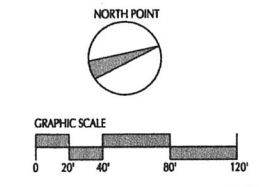

MARK	DATE	DESCRIPTION
1	11/30/12	Preliminary Site Development Plan

BY: \_\_\_\_\_

Client: Winwood Marketplace Holdings LLC  
Project: University Avenue Redevelopment  
University Station - University Avenue  
Landscape Plan

Project No.: 127-3659-12003  
Designed By: JPS  
Drawn By: SC/JVM  
Checked By: RJ/JPS

**L-101**

Copyright: Tetra Tech

Bar Measures 1 inch

11/30/2012 4:50:51 PM - Z:\PROJECTS\UNIVERSITY STATION\CADSWA\CAD\CD-PLAN.DWG - YERINA MANEVA

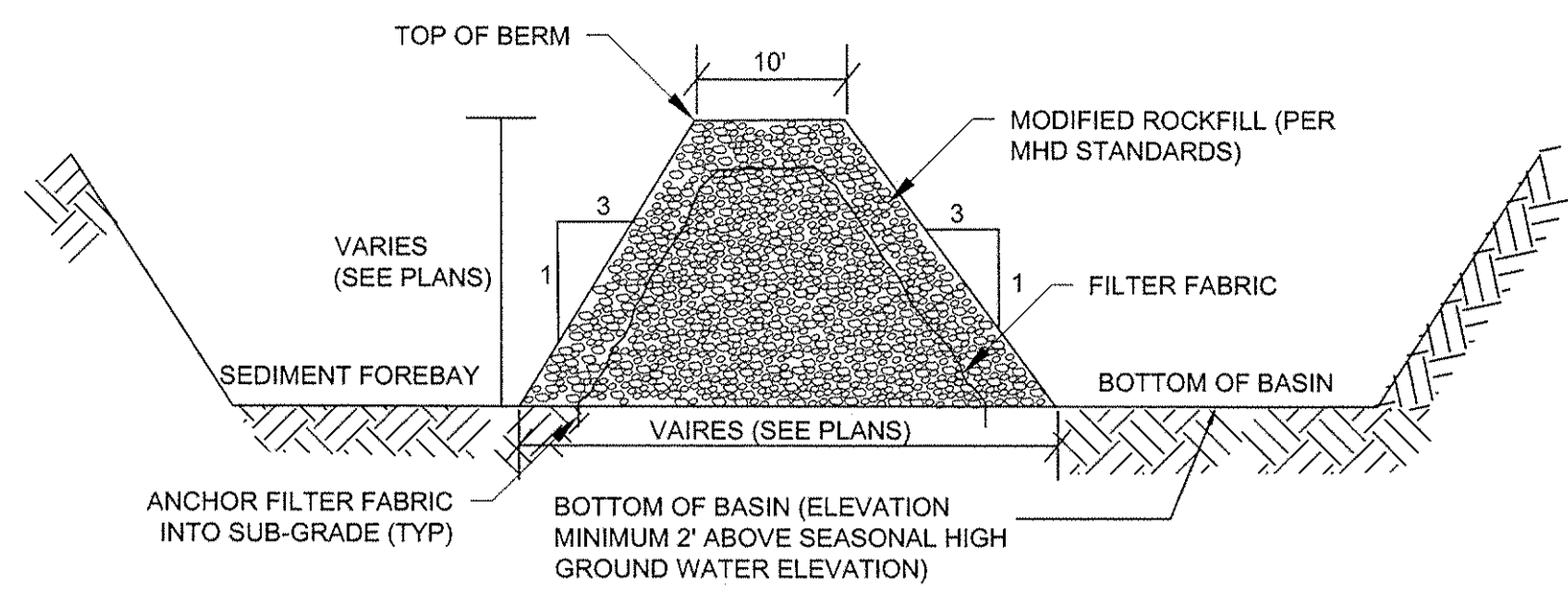

**SEDIMENT FOREBAY BERM DETAIL**  
N.T.S.

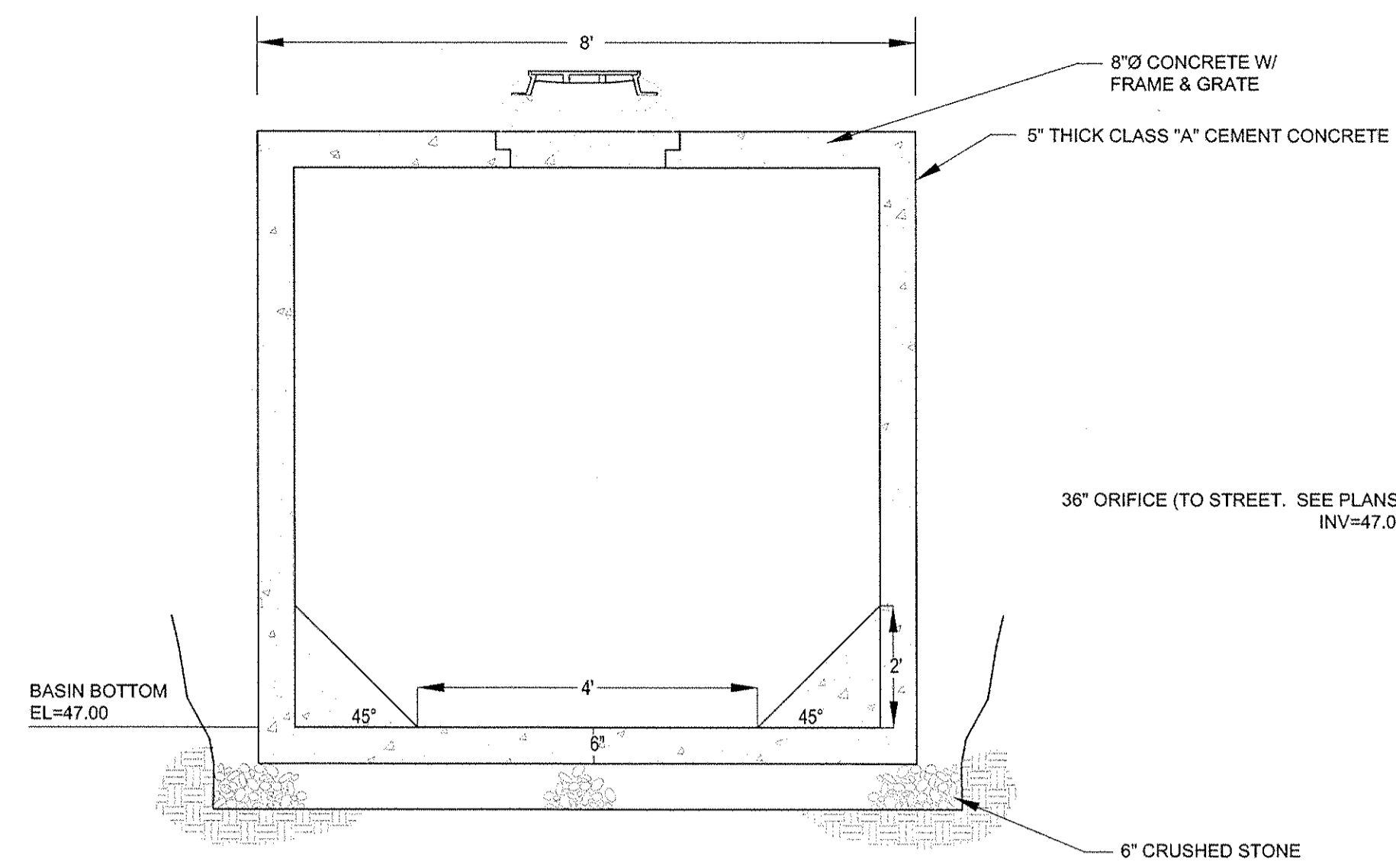

1. INSTALL CONCRETE ANTI-SEEP COLLARS ON ALL PIPES AND PENETRATIONS THROUGH EARTHEN BERMS THAT IMPOUND WATER.  
**POND 30P OUTLET STRUCTURE DETAIL**  
N.T.S.

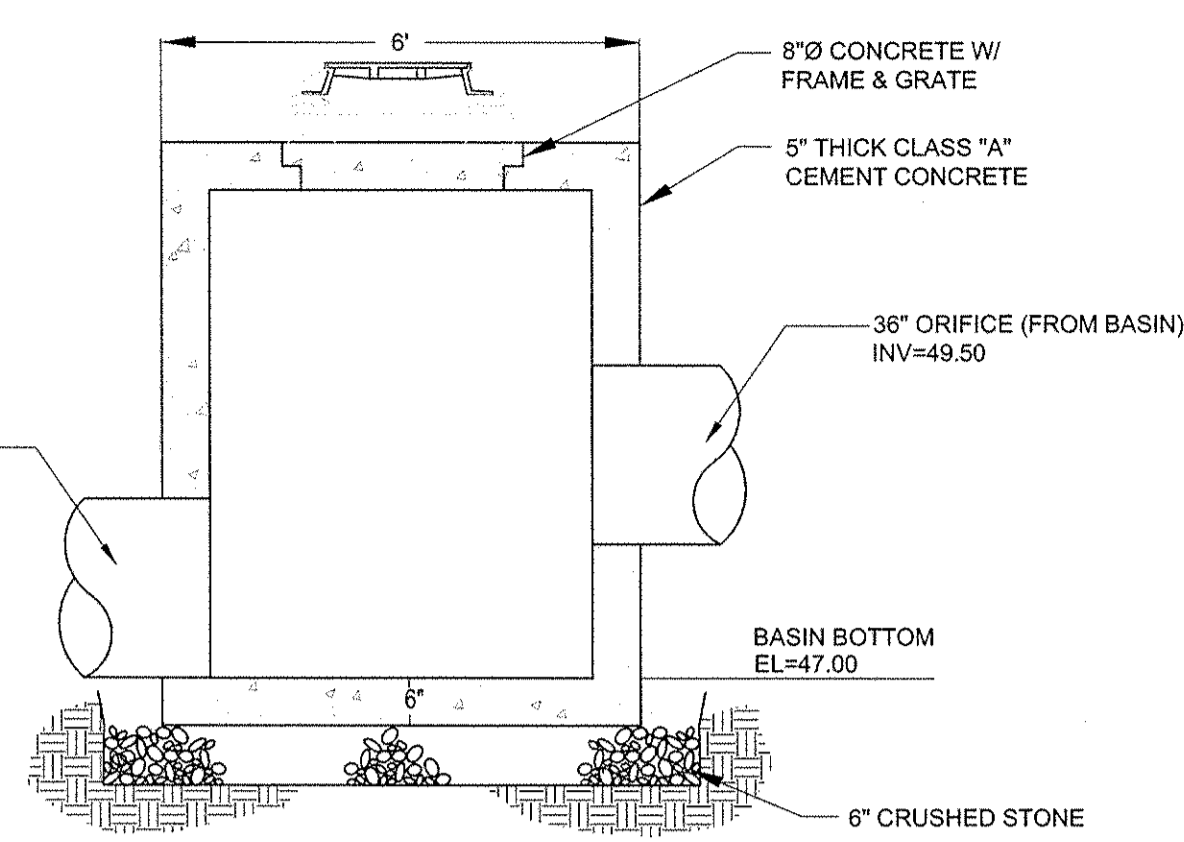

1. INSTALL CONCRETE ANTI-SEEP COLLARS ON ALL PIPES AND PENETRATIONS THROUGH EARTHEN BERMS THAT IMPOUND WATER.  
**BASIN 52.1P OUTLET STRUCTURE DETAIL**  
N.T.S.

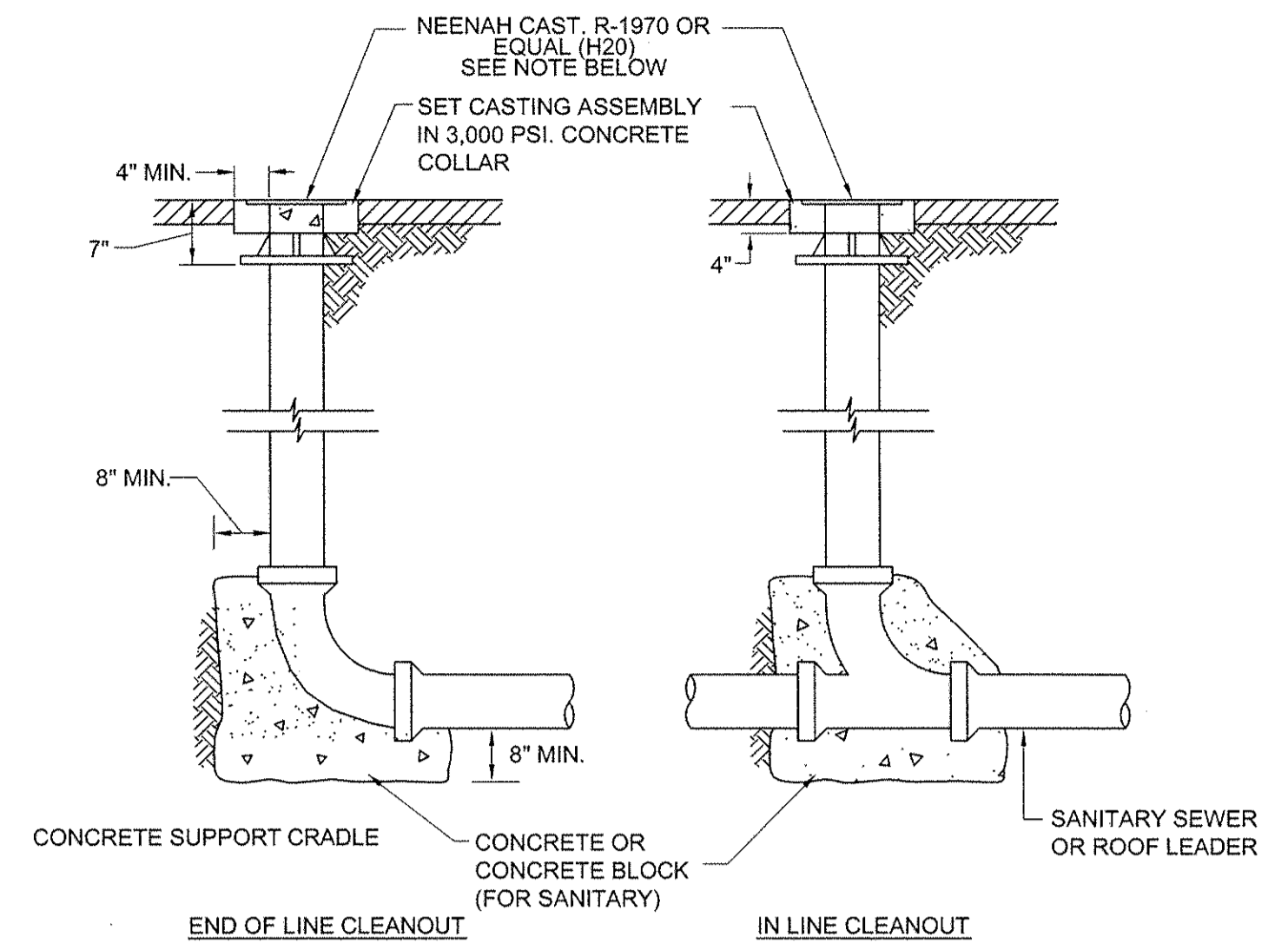

NOTES:  
1. CLEANOUT TOP SHALL BE ENCLOSED IN CASTING AND/OR FABRICATED COVER ASSEMBLY.  
2. IN NON-PAVED AREAS, THE PVC PLUG OF THE CLEANOUT SHALL BE COVERED BY A SEWER CLEANOUT RING AND COVER AS MADE BY LABARON FOUNDRY (LA 0910)

**CLEANOUTS**  
N.T.S.

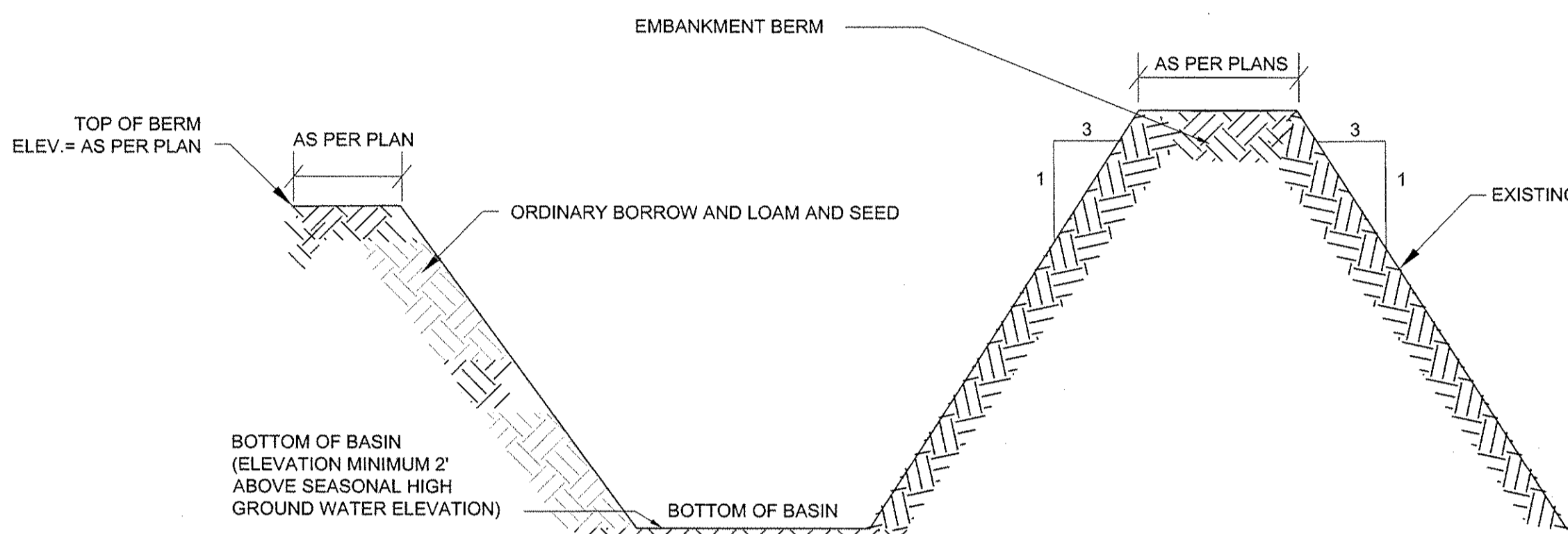

- NOTE:  
1. BASIN SIDE SLOPES AND BOTTOM SHALL BE PROVIDED WITH 4 INCHES OF LOAM, SEEDED AT A RATE OF 2 POUNDS RED TOP, 15 POUNDS CREEPING RED FESCUE, 20 POUNDS TALL FESCUE PER ACRE. AT NO TIME SHALL A SEED MIX CONSIST OF MORE THAN 10% ANNUAL RYES.  
2. BASIN SLOPES SHALL BE 3:1 SLOPE  
3. BASIN FLOOR SHALL BE SEEDED WITH "EROSION CONTROL/RESTORATION MIX FOR DETENTION BASINS AND MOIST SITES" AS MANUFACTURED BY NEW ENGLAND WETLAND PLANTS, INC. OR APPROVED EQUAL.

**CROSS-SECTION OF TYPICAL DETENTION BASIN DETAIL**  
N.T.S.

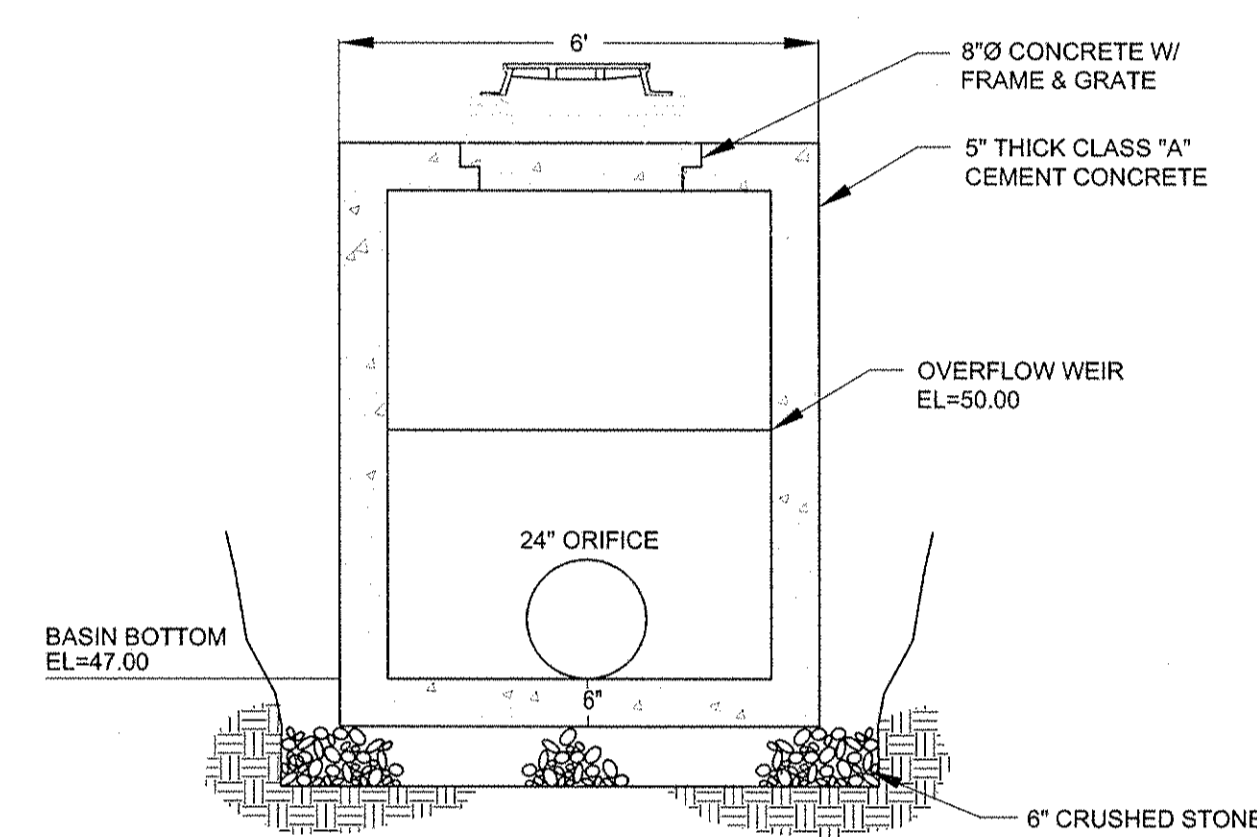

1. INSTALL CONCRETE ANTI-SEEP COLLARS ON ALL PIPES AND PENETRATIONS THROUGH EARTHEN BERMS THAT IMPOUND WATER.  
**BASIN 52.2P OUTLET STRUCTURE DETAIL**  
N.T.S.

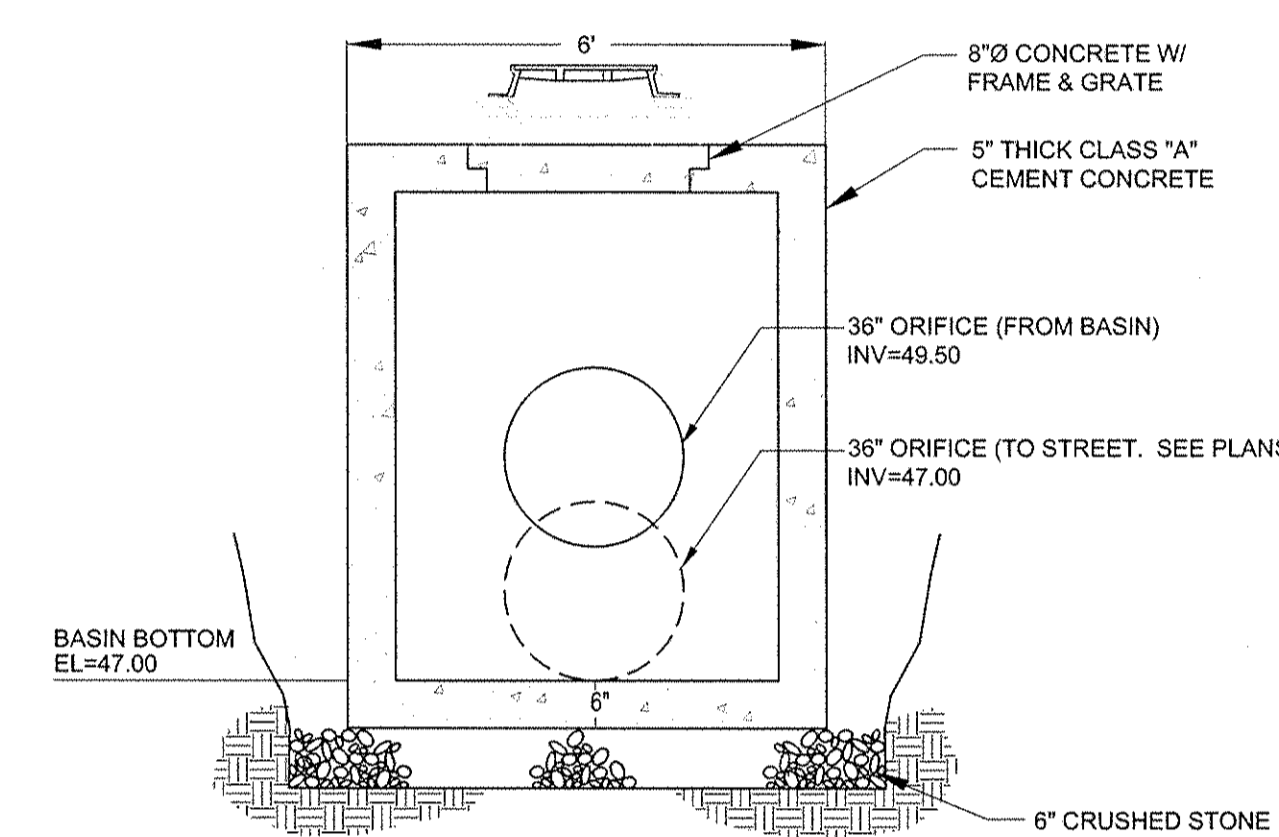

1. INSTALL CONCRETE ANTI-SEEP COLLARS ON ALL PIPES AND PENETRATIONS THROUGH EARTHEN BERMS THAT IMPOUND WATER.  
**BASIN 52.1P OUTLET STRUCTURE DETAIL**  
N.T.S.

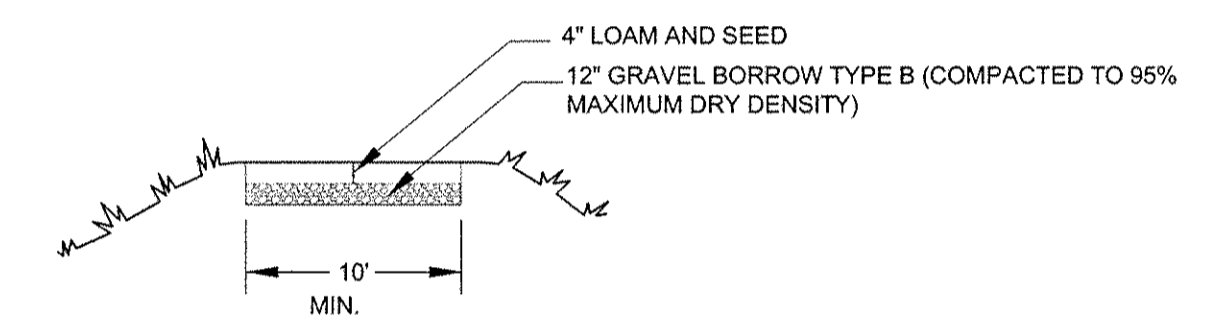

**DETENTION POND MAINTENANCE ACCESS ROAD**  
N.T.S.

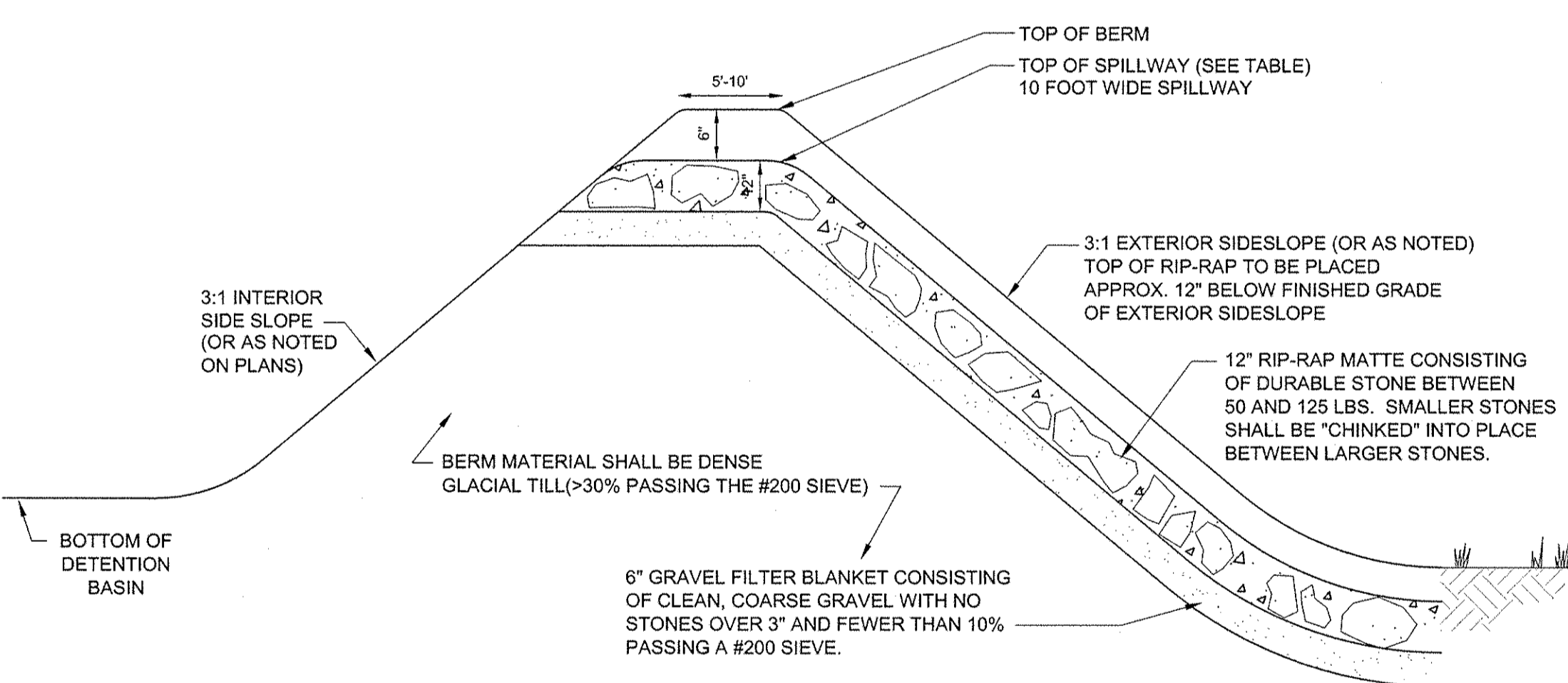

**CROSS-SECTION OF TYPICAL DETENTION BASIN EMERGENCY SPILLWAY**  
N.T.S.

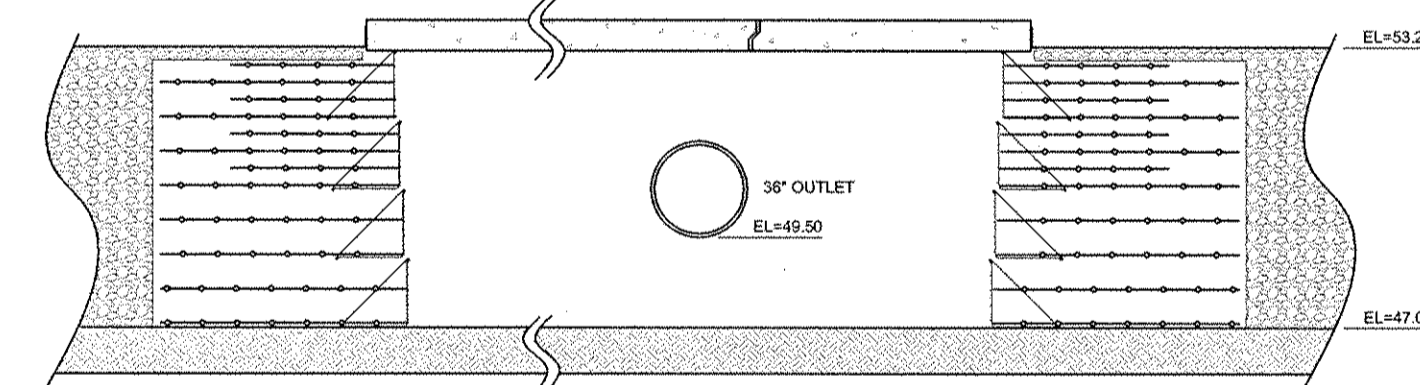

**INFILTRATION BASIN 10P OUTLET**  
N.T.S.

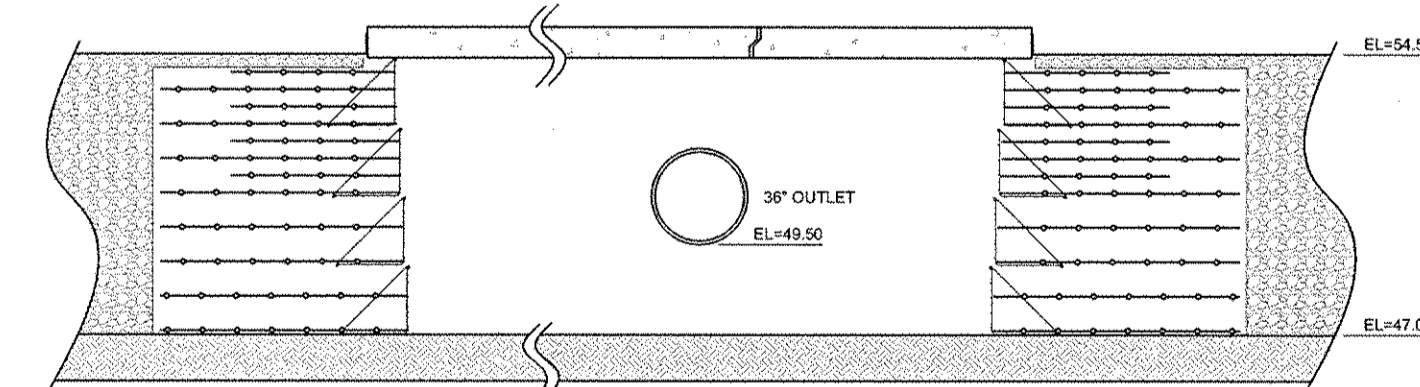

**INFILTRATION BASIN 11P OUTLET**  
N.T.S.

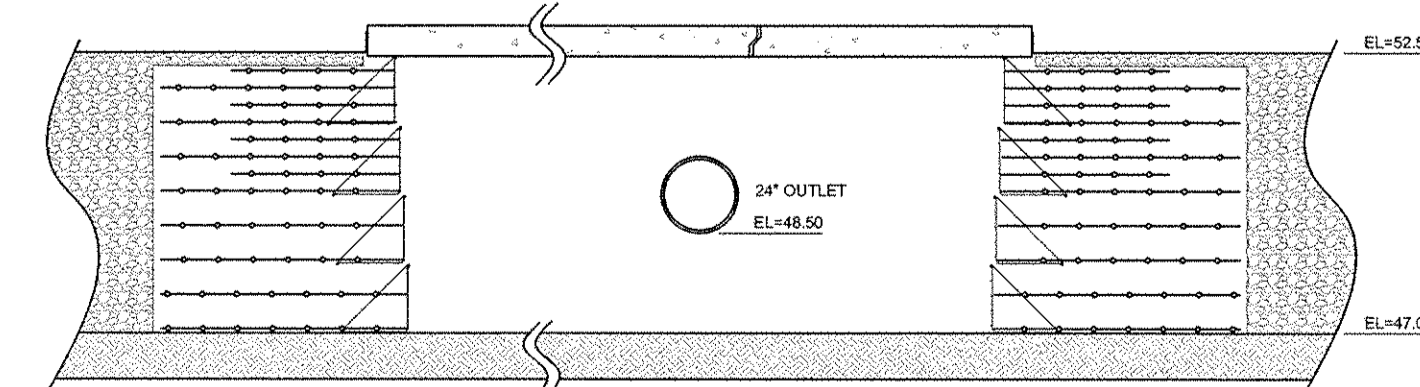

**INFILTRATION BASIN 59P OUTLET**  
N.T.S.

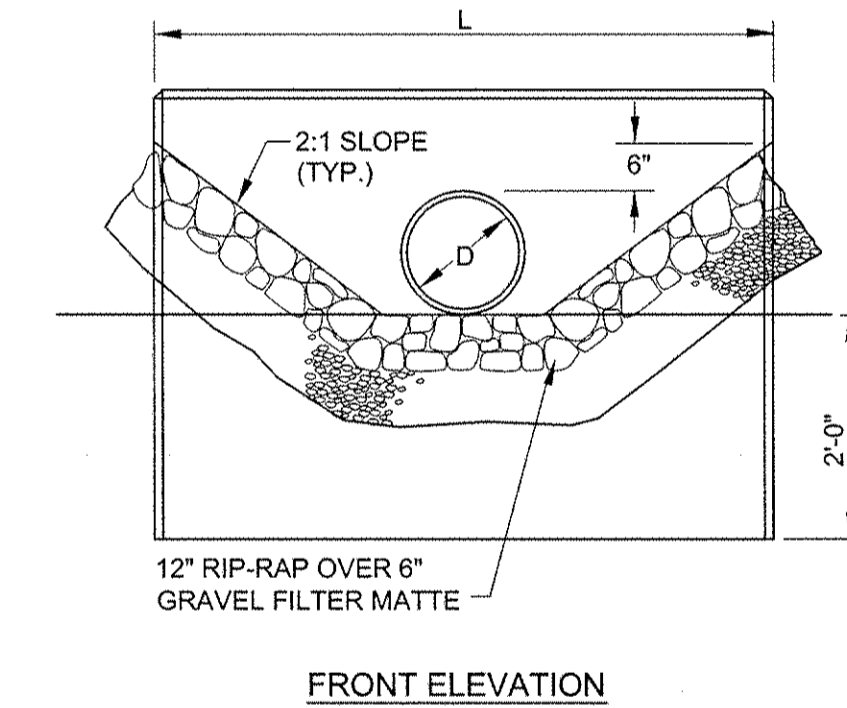

**FRONT ELEVATION**

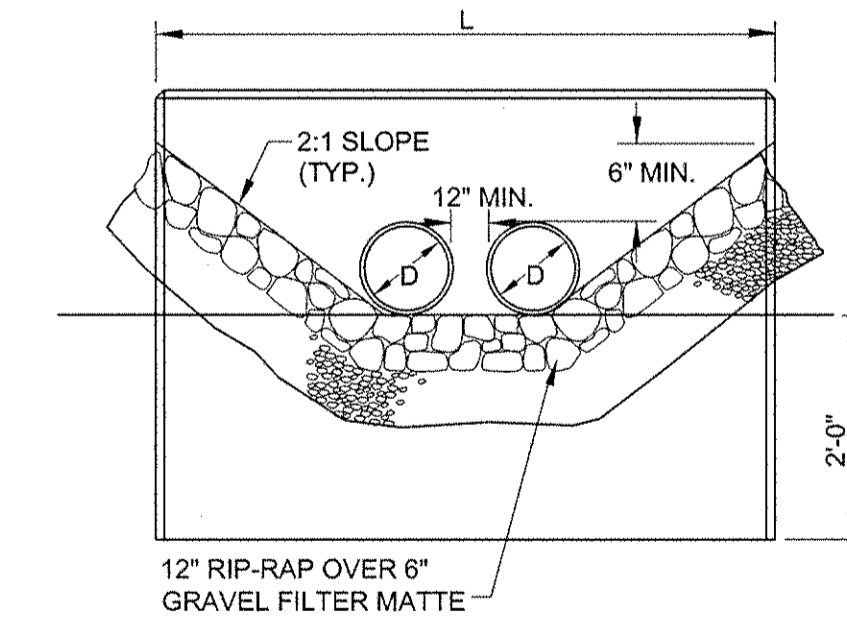

**FRONT ELEVATION**

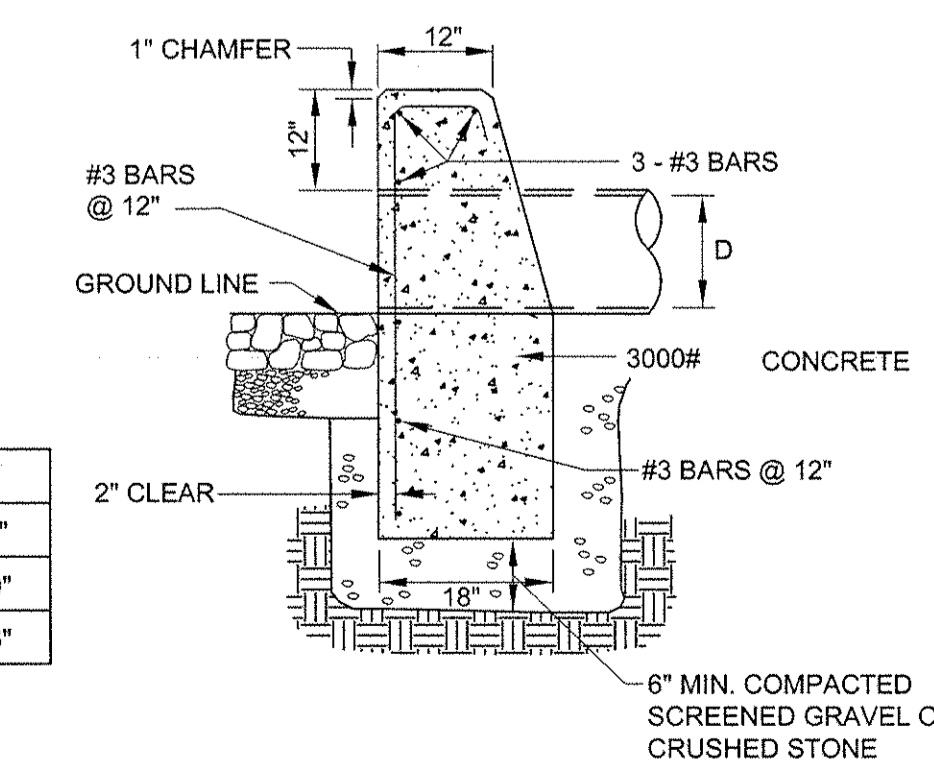

**END ELEVATION**

D	L
15"	8'-9"
18"	10'-0"
24"	12'-6"

**HEADWALL DETAIL**  
N.T.S.

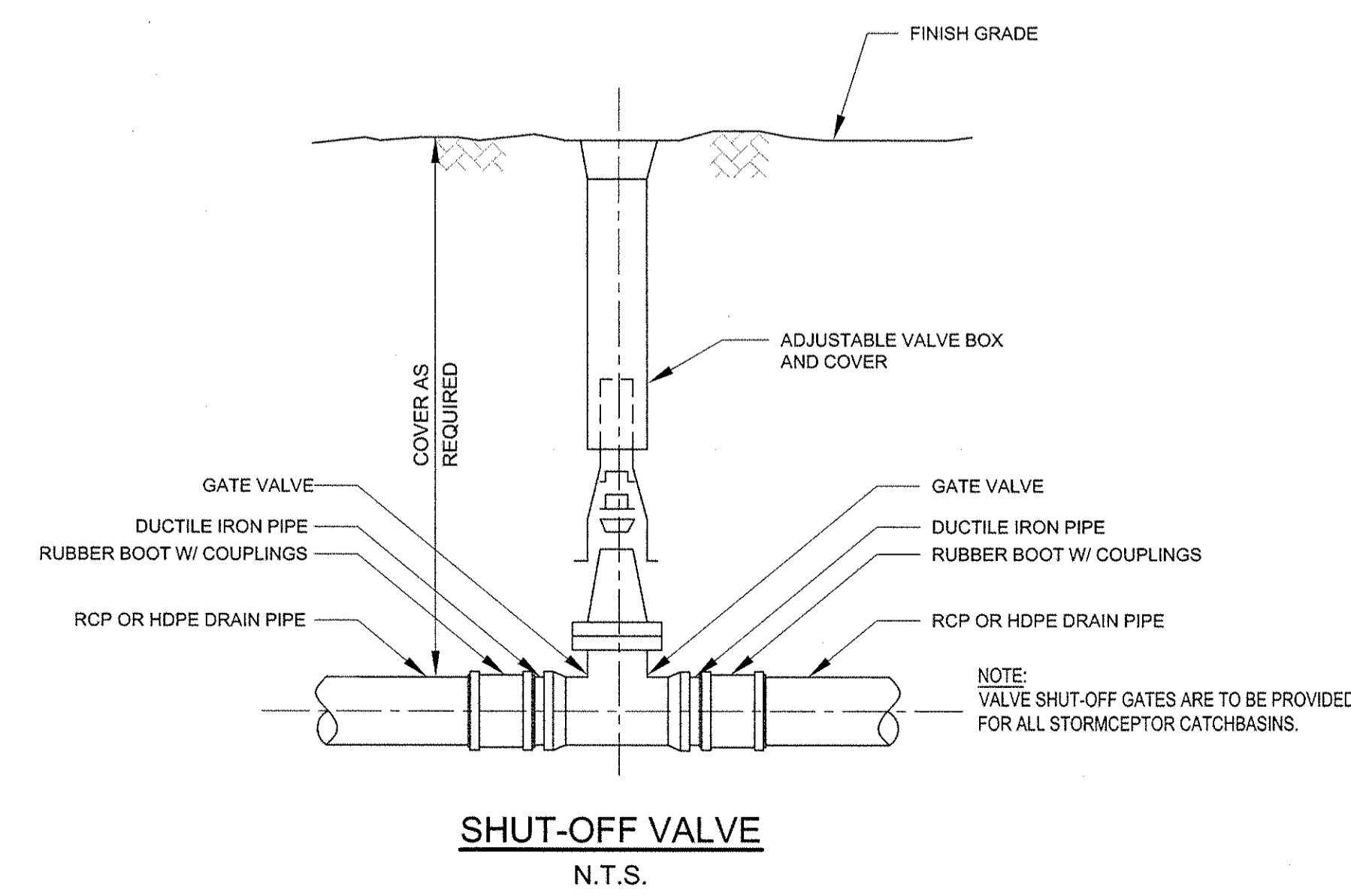

**SHUT-OFF VALVE**  
N.T.S.

MARK	DATE	DESCRIPTION	BY
1	10/9/12	Preliminary Site Development Plans	N.H.C.
2	11/20/12	Revised Site Development Plans	N.H.C.

11/29/2012 11:51:21 AM - P:\3659\127-3659-12003\CAD\SHEETFILES\SITE DEVELOPMENT PLANS\C-500 DETAIL SHEETS.DWG - BECKWITH, JOHN