



**TOWN OF WESTWOOD
COMMONWEALTH OF MASSACHUSETTS**

**INVITATION FOR BIDS
Westwood High School Practice Field
Bid # DPW-22-B-023
Addendum 01
March 30, 2022**

I. GENERAL INFORMATION

Addendum 01 extends the bid due date until **11:30 am on April 5, 2022.**

Addendum 01 confirms there were two attendees at the Pre-Bid Meeting. Attendees were:

- John Chaffin, RAD Sports, 508.400.0955
- Ryne Drummonds, Hellas Construction, 706.483.2428

Addendum 01 answers the following questions:

- Q1 Does the Town want hash marks on the field (Base Bid)?
A1 Yes, the Town wants football field hash marks on the field – They should be the same color (white) as the football field striping and sewn in.
- Q2 How will the grade be handled at the back of the concrete pads (Add Alternate #4) where it will end up above the grade of the concrete pad?
A2 Where the grade at the back of the concrete pad is less than 6", the grade should be gently sloped to meet the existing lawn area and re-seeded. Where the grade at the back of the concrete pad is 6" or more, a pre-cast concrete curb shall be used to retain the grade. See Addendum 01b (former sheet 8 in bid set).
- Q3 How should the concrete pads be pitched for drainage (Add Alternate #4)?
A3 The concrete pads should be pitched a minimum of 1% towards the track due to the grades of the lawn area. See Addendum 01b (former sheet 8 in bid set).
- Q4 Can the soil removed for the concrete pads (Add Alternate #4) be spread on site and seeded over?
A4 Any extra soil removed for the concrete pads cannot be re-spread on site and must be removed off site legally and appropriately.
- Q5 Can the refurbishment of the chain link fencing (Add Alternate #3) be changed to a contingency-base bid item with a site walk with the Town to identify specific repairs to be made?
A5 No, the refurbishment of the chain link fence will remain as is in the contract documents.



TOWN OF WESTWOOD COMMONWEALTH OF MASSACHUSETTS

- Q6 Will the Town consider the removal of Add Alternate #3 from the project entirely?
A6 No, the refurbishment of the chain link fence will remain as is in the contract documents.
- Q7 You specify 36-50 oz fiber weight per sq ft. Can you be precise?
A7 The fiber weight per square foot shall be 46 oz per square foot.
- Q8 Can you provide more precise information regarding fiber height?
A8 Fiber height shall be 2 ½”.
- Q9 You call for Pea Stone for ballast. Seeing as 100% of the fields in New England that use sand use clean silica sand would that be acceptable
A9 The Town has decided to maintain the specification for pea stone based on factors such as nearby field experience, the current and anticipated year-round high usage rate of the field, and its concerns with compaction over time
- Q10 You call for cuboidal rubber. Again, seeing as 100% of the fields in New England use either cryogenic or ambient processed crumb rubber (which was also what we were standing on) would that be acceptable as well?
A10 Cuboidal rubber is the preferred option, cryogenic will be considered, and ambient processed rubber will not be considered.
- Q11 Please confirm there is 572 LF of 10’ high black vinyl chain link fence being removed and replaced (Add Alternate #3). How many gates are needed in the replaced gates?
A11 Add Alternate #3 is being bid as a Lump Sum for any damaged fence work to be repaired it is not expected that the entire length of fencing will need to be replaced or refurbished. There is approximately 566 LF of 10’ black vinyl-coated chain link at the practice field. There are no gates existing on site and so none are required for the project work
- Q12 Alternate #2, please provide the exact scope of work for this alternate. Confirm depth of mill and replace.
A12 The exact depth of the top course is not known, there haven’t been any examinations of the paving to definitively say. The intent is for the top course to be milled and overlaid. It is assumed that the bituminous concrete pavement has been installed in typical fashion and thus the top course is assumed to be 1 ½”. The detail provided on sheet 8 of the plan set is a standard bituminous asphalt detail meant for reference and not intended to direct bidders to replace the full depth.
- Q13 Alternate #4 has no detail for a grading plan at the bleacher pads. Need to know if dirt needs to be taken off. If dirt needs to be removed, do we need to dispose of it? Is there a place onsite we can store the extra excavated material? Which type of sod laid or overseed?



TOWN OF WESTWOOD COMMONWEALTH OF MASSACHUSETTS

- A13 See numbers 2 and 4 in Questions from Pre-Bid Meeting for first parts of this question. If excavated materials are fit for required back-filling on site, they may be used to do so per the Specifications. Any materials not to be repurposed on site must be disposed of properly and promptly. Seed for disturbed areas shall be per Section 02920- - Loaming and seeding.
- Q14 Alternate #4 – preparing the lawn area for bleacher placement – is this for future bleachers or does the school want the contractor to provide a number for the bleachers? Please confirm scope of work. Please provide bleacher specification if needed.
- A14 Alternate #4's scope is only for the concrete pads which are meant to have the existing bleachers re-set in those locations. There is no need to provide any new bleachers.
- Q15 On sheet #4 (in the plan set) it states, "Base Bid: Proposed synthetic turf curb and proposed player benches." Please confirm this a reference and no work to existing curb or new players' benches.
- A15 On sheet #4 in the plan set there are few erroneous callouts. See attached for clarity. The concrete curbs are not a part of the scope nor are any players' benches. See Addendum 01a (former sheet 4 in bid set).
- Q16 Will there be a Conference Call to dial into the bid opening?
- A16 The third paragraph on page 1 of Part I, Paragraph I., general Information and Proposal Submission Requirements, is deleted. Bid results will be posted to the Town website by the end of the day.
- Q17 The bid documents look as if there is a preferred brand. Are bidders able to bid different brands?
- A17 Please note that per Section 02790, Part 2.02, G. 1: Manufacturer/Turf Installer meeting or surpassing specifications herein may be considered in this non-proprietary public project. While a specific product was used as a basis for the product based upon the Town's preferred outcome and projected long-term viability, statute always offers for a bidder to propose an 'As Equal' product. Material, or process.



**TOWN OF WESTWOOD
COMMONWEALTH OF MASSACHUSETTS**

II. ADDENDUM 01 RECEIPT ACKNOWLEDGEMENT FORM

BIDDERS MUST ACKNOWLEDGE RECEIPT OF ADDENDUM WITH THE BID SUBMITTAL.

Signature _____

Name _____

(Please Print)

Title _____

Company _____

Date _____

End of Addendum No. 1

NO.	DATE	DESCRIPTION
1	02/23/22	AS BUILT - AS SHOWN
2		
3		
4		
5		
6		
7		
8		
9		
10		
11		
12		
13		
14		
15		
16		
17		
18		
19		
20		
21		
22		
23		
24		
25		
26		
27		
28		
29		
30		
31		
32		
33		
34		
35		
36		
37		
38		
39		
40		
41		
42		
43		
44		
45		
46		
47		
48		
49		
50		
51		
52		
53		
54		
55		
56		
57		
58		
59		
60		
61		
62		
63		
64		
65		
66		
67		
68		
69		
70		
71		
72		
73		
74		
75		
76		
77		
78		
79		
80		
81		
82		
83		
84		
85		
86		
87		
88		
89		
90		
91		
92		
93		
94		
95		
96		
97		
98		
99		
100		

NO.	DATE	DESCRIPTION
1	02/23/22	AS BUILT - AS SHOWN
2		
3		
4		
5		
6		
7		
8		
9		
10		
11		
12		
13		
14		
15		
16		
17		
18		
19		
20		
21		
22		
23		
24		
25		
26		
27		
28		
29		
30		
31		
32		
33		
34		
35		
36		
37		
38		
39		
40		
41		
42		
43		
44		
45		
46		
47		
48		
49		
50		
51		
52		
53		
54		
55		
56		
57		
58		
59		
60		
61		
62		
63		
64		
65		
66		
67		
68		
69		
70		
71		
72		
73		
74		
75		
76		
77		
78		
79		
80		
81		
82		
83		
84		
85		
86		
87		
88		
89		
90		
91		
92		
93		
94		
95		
96		
97		
98		
99		
100		

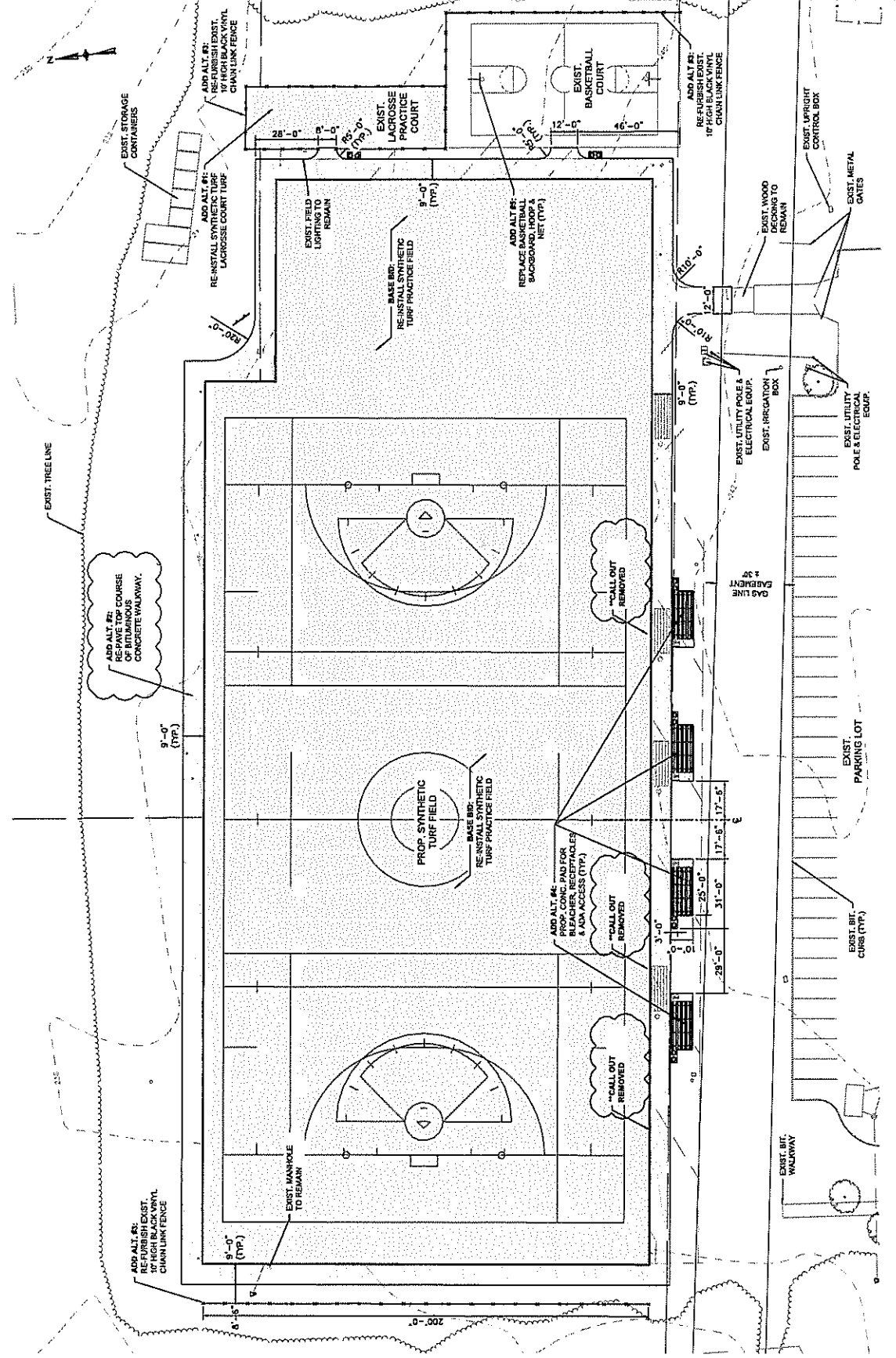

SYNTHETIC FIELD NOTES:
 1. SEE SPECIFICATIONS FOR SYNTHETIC TURF INSTALLATION AND DESIGN.
 2. COORDINATE WITH CLIENT FOR FINAL APPROVAL OF COLORS, STRIPING AND ANY GRAPHICS.

BASE BID:
 SERVING IN OF FOLLOWING SPORT LINES INTO SYNTHETIC TURF:
 • SOCCER - YELLOW
 • LACROSSE - BLUE
 • FIELD HOCKEY - RED

NOTES:
 BASE BID: REMOVAL & REINSTALLATION OF SYNTHETIC TURF PRACTICE FIELD, SEE SPECIFICATIONS.
 ADD ALT #1: REMOVAL & REINSTALLATION OF SYNTHETIC TURF LACROSSE COURT TURF.
 ADD ALT #2: REPAIR TOP COURSE OF BITUMINOUS CONCRETE WALKWAY.
 ADD ALT #1: RE-FURNISH CHAIN LINK FENCES.
 ADD ALT #1: INSTALL NEW CONCRETE PADS FOR BLEACHERS.
 ADD ALT #1: REPLACE BASKETBALL BACKBOARDS, HOOPS & NETS.

SCALE
 1" = 20'
 SCALE WHEEL: 1/2" = 10'

1. PROJECT NUMBER	2002-010
2. DATE	11/20/02
3. DRAWN BY	SAVC
4. CHECKED BY	Rc
5. ISSUE DATE	01/20/02
6. BETA JOB NO.	2728
SCALE	AS SHOWN

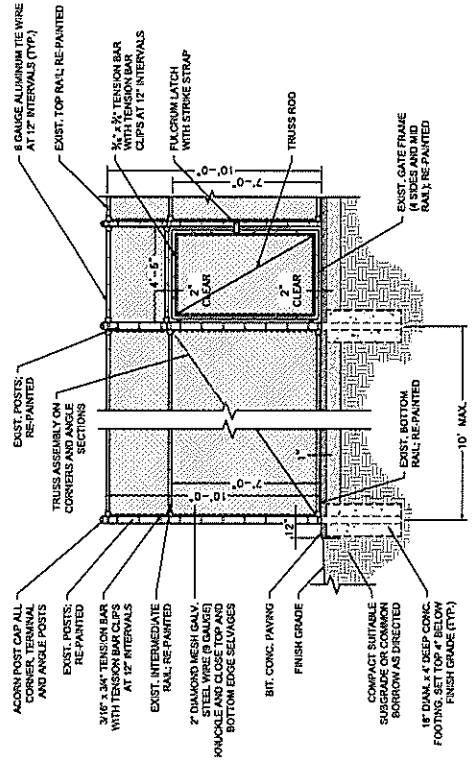

ADD ALT. #1: 10' HIGH BLACK VINYL CHAIN LINK FENCE
 SCALE: 1"=1'-0"

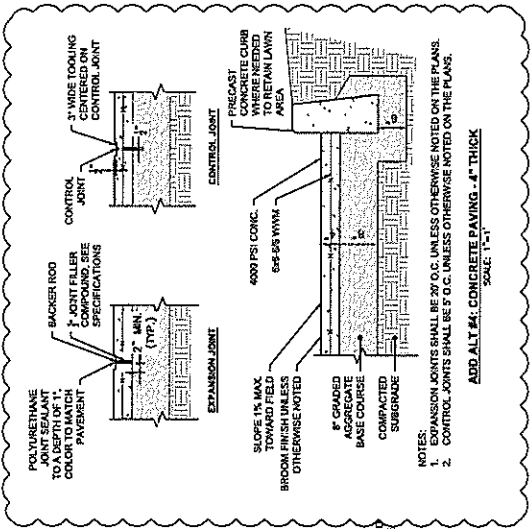

ADD ALT. #4: CONCRETE RAVING - 4\"/>
 SCALE: 1"=1'-1"

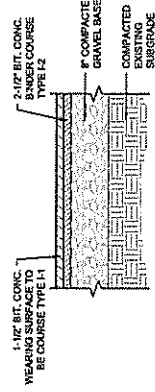

ADD ALT. #2: BITUMINOUS PAVING
 SCALE: 1"=1'-0"