

PROGRAM OF STRUCTURAL TESTS AND INSPECTIONS

FOR COMPLIANCE WITH CHAPTER 17 OF THE 9TH EDITION OF THE MASSACHUSETTS STATE BUILDING CODE

THE OWNER WILL EMPLOY A TESTING AGENCY (SELECTED BY THE ENGINEER/OWNER) TO PERFORM STRUCTURAL TESTS AND INSPECTIONS AS INDICATED ON THIS SHEET. TEST REPORTS SHALL BE ADDRESSED TO THE OWNER & SENT DIRECTLY TO THE OWNER & MCBRIE, LLC FROM THE TESTING AGENCY.

OWNER: TOWN OF WESTWOOD

OWNER'S ADDRESS: 240 NAHANT STREET WESTWOOD, MA

ARCHITECT OF RECORD: N/A

STRUCTURAL ENGINEER OF RECORD (SER): MICHAEL PERHAM, MCBRIE, LLC

THE FOLLOWING FIRMS, AGENCIES, OR INDIVIDUALS (HEREINAFTER REFERRED TO COLLECTIVELY AS AGENTS) WILL PERFORM THE TESTS AND INSPECTIONS UNDER THE DIRECTION OF THE SER:

ABBREVIATION	AGENT
SER	STRUCTURAL ENGINEER OF RECORD (LISTED ABOVE)
OTS	OWNER'S TESTING SERVICE
N/A	NOT APPLICABLE FOR THIS PROJECT

THE ABBREVIATIONS WILL BE USED TO IDENTIFY WHICH AGENT IS PERFORMING THE PARTICULAR TESTS OR INSPECTIONS.

"IN ACCORDANCE WITH SPECIFICATIONS" IN THE ITEM/SCOPE SHALL INCLUDE THE MASSACHUSETTS STATE BUILDING CODE, CHAPTER 17 AND THE SPECIFICATION FOR EACH MATERIAL AS INDICATED IN THE NOTES ON THIS SHEET (S1) UNDER EACH MATERIAL HEADING

THE FOLLOWING CATEGORIES OF STRUCTURAL TESTS AND INSPECTIONS ARE INCLUDED IN THE PROGRAM FOR STRUCTURAL TESTS AND INSPECTIONS FOR THIS PROJECT.

STEEL CONSTRUCTION

ITEM/SCOPE	AGENT
1. FABRICATOR CERTIFICATION/QUALITY CONTROL PROCEDURES: REVIEW EACH FABRICATOR'S QUALITY CONTROL PROCEDURES	N/A
2. FABRICATOR INSPECTION(1705.4.2 & R1705.4.2): INSPECT IN-PLANT FABRICATION, OR REVIEW FABRICATOR'S APPROVED INDEPENDENT INSPECTION AGENCY'S REPORTS.	N/A
3. MATERIAL CERTIFICATION: REVIEW FOR CONFORMANCE TO THE SPECIFICATIONS.	SER
4. BOLTING: TEST AND INSPECT BOLTED CONNECTIONS IN ACCORDANCE WITH SPECIFICATIONS. VERIFY BOLT SIZE AND GRADE.	OTS
5. WELDING: CHECK WELDER QUALIFICATIONS. VISUALLY INSPECT FILLET WELDS AND TEST FULL-PENETRATION FIELD WELDS IN ACCORDANCE WITH SPECIFICATIONS.	OTS
7. STRUCTURAL FRAMING, DETAILS AND ASSEMBLIES: INSPECT FOR SIZE, GRADE OF STEEL, CAMBER, INSTALLATION AND CONNECTION DETAILS. CHECK AGAINST APPROVED CONSTRUCTION DOCUMENTS AND SHOP DRAWINGS.	SER

CAST-IN-PLACE CONCRETE CONSTRUCTION

ITEM/SCOPE	AGENT
1. MIX DESIGN: REVIEW MIX DESIGNS.	SER
2. MATERIALS CERTIFICATION: REVIEW FOR CONFORMANCE TO SPECIFICATIONS.	SER
3. BATCHING PLANT: REVIEW PLANT QUALITY CONTROL PROCEDURES AND BATCHING AND MIXING METHODS.	N/A
4. REINFORCEMENT INSTALLATION: INSPECT REINFORCING FOR SIZE, QUALITY, CONDITION AND PLACEMENT.	SER/OTS
5. FORMWORK GEOMETRY: INSPECT FORM SIZES.	SER

- 6. CONCRETE PLACEMENT: OTS
OBSERVE CONCRETE PLACEMENT OPERATIONS. VERIFY CONFORMANCE TO SPECIFICATIONS INCLUDING COLD-WEATHER AND HOT-WEATHER PLACEMENT PROCEDURES. PERFORM SLUMP, DENSITY AND AIR CONTENT TESTS AT POINT OF DISCHARGE.
- 7. EVALUATION OF CONCRETE STRENGTH: OTS
TEST AND EVALUATE IN ACCORDANCE WITH THE SPECIFICATIONS.
- 8. CURING AND PROTECTION: OTS
OBSERVE PROCEDURE FOR CONFORMANCE TO THE SPECIFICATIONS.

NEW SECTION OF COLUMN TO MATCH EXISTING SIZE AND SHALL BE HOT DIPPED GALV. W/ FINISH COAT TO MATCH EXISTING

SILICONE CAULK ALL AROUND COLUMN

5000 PSI HIGH EARLY, FULL STRENGTH @ 7 DAY CONCRETE SLAB WITH 6X6-W2.9X2.9 WWF SET 2" FROM THE TOP, TAPER SLAB AWAY FROM COLUMN

FULL PENETRATION GROOVE FIELD WELD ALL AROUND - PROVIDE INTERNAL HSS SLEEVE FOR WELD BACKER

GALV. BASE PLATE ON SKIM COAT OF NON-SHRINK GROUT W/4-1/2Ø EXPANSION BOLTS (HILTI KWIK BOLT OR EQUAL) WITH 3" MIN. EMBEDMENT

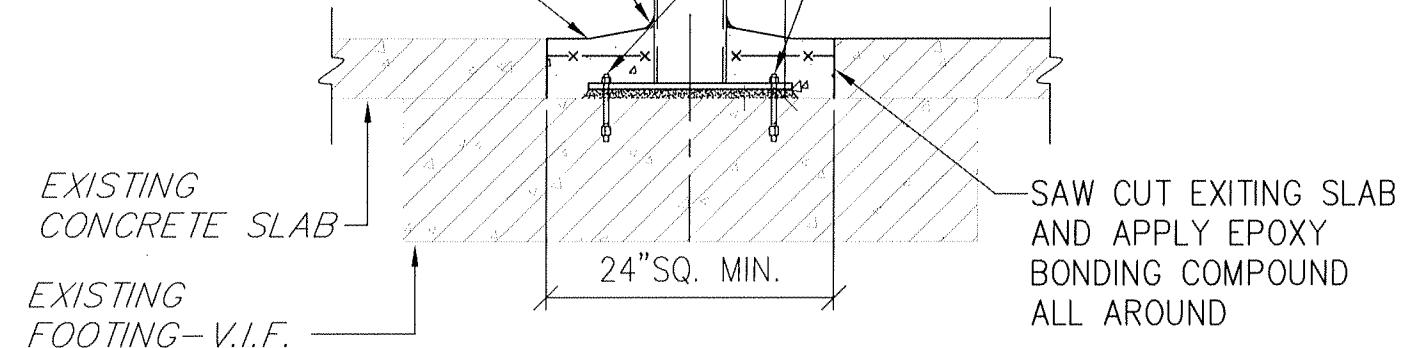

COLUMN REPAIR DETAIL
SCALE: 3/4" = 1'-0"

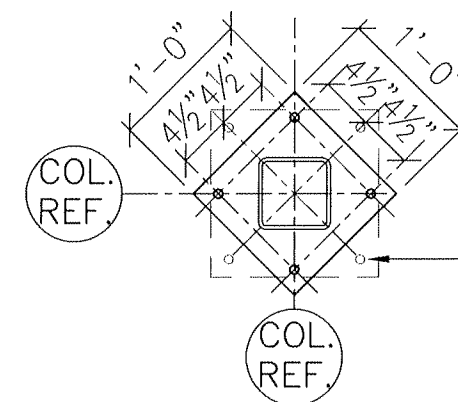

HSS BASE DETAIL

ASSUMED EXISTING ANCHOR BOLTS T.B.R. VERIFY LAYOUT VS EXISTING ANCHOR BOLT LAYOUT

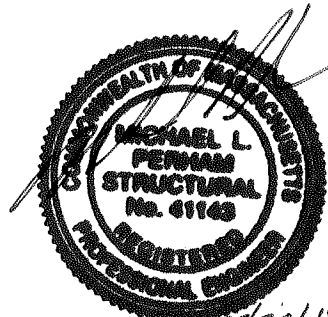

NO.	DATE	REVISIONS

PREPARED FOR:
NIV5
200 BRICKSTONE SQUARE
ANDOVER, MA 01810

COLUMN REPAIR
WESTWOOD RECREATION POOL
240 NAHANT STREET
WESTWOOD, MA
MCBRIE, LLC PROJECT #19-080

DRWN BY: WH
CHK'D BY: MLP
DATE: 05/20/18

McBrie, LLC
Structural Design & Sales
160 SYLVAN STREET
2nd FLOOR
DANVERS, MA 01923
TEL: 978-646-0087
FAX: 978-646-0087
WWW.MCBRIE.COM

PROGRAM OF
STRUCTURAL TESTS
COLUMN DETAIL

S2